



**NOTIFICATION TO ATTEND MEETING OF THE NORTH WEST AREA COMMITTEE
TO BE HELD IN THE CONFERENCE ROOM - BALLYMUN CIVIC OFFICES
ON TUESDAY 16 MAY 2017 AT 2.30 PM**

AGENDA

TUESDAY 16 MAY 2017

		PAGE
1	Minutes of the North West Area Committee Meeting held on Tuesday 18th April 2017	1 - 4
2	Questions to the Area Manager	5 - 10
3	Cabra Area Office Report, Fergus Synnott, Administrative Officer	11 - 16
4	Update on mid plan review of the Ashtown/Pelletstown LAP, Cáit Ryan, Executive Planner	17 - 18
5	Luas Broombridge Presentation - Ciaran Browne, Project Manager, Lucas Cross City	
6	Housing Cabra/Finglas Report, Derek Healy, Housing Manager	19 - 24
7	Verbal Update on the status of the Part 8 for Scribblestown, James Nolan, Executive Engineer and Mary Davis, Staff Officer, Social Housing PPP Bundle 1	
8	Finglas Area Office Report, Aidan Maher, Assistant Area Manager	25 - 28
9	Presentation on Kildonan Lands, Pauline Byrne, Rafal Nieznalski and Sorcha Turnbull, Brady Shipman Martin	
10	Presentation on St Helena's House, Audrey Cruise, Manager, St. Helena's House	
11	Motion in the name of Councillor Paul McAuliffe	
	The North West Area Committee call on DCC to investigate traffic flows and parking on the North Road following the opening of several businesses and the expected opening of the crèche.	
12	Motion in the name of Councillor Paul McAuliffe	

Arising from an email to all Councillors by the Combined Finglas South Residents Association, The North West Area Committee call on the Area Manager to establish a process to plan future growth in social, affordable and private housing in the Finglas Area. This process should identify the amount of development land in the area and make a recommendation if a statutory Local Area Plan is required or if another plan format will help identify future service needs.

13	Public Domain Report, John Twamley, Public Domain Officer	29 - 32
14	Sports & Wellbeing Partnership Report	33 - 36
15	Traffic Service Requests, Status Report	37 - 74
16	Minutes of the Traffic Advisory Group (TAG) Meeting	75 - 84
17	Motion in the name of Councillor Anthony Connaghan	

That the Manager provides this Area Committee with a full list of works by utilities companies in relation to road and footpath openings in tabular form giving dates when openings occurred and when works to re-instate had been finalised or when they are due to be finalised.

18	Ballymun Area Office Report, Mary Taylor, Assistant Area Manager	85 - 94
19	Verbal Update on the Consultative Forum for the Oscar Traynor Lands, Connell McGlynn, Project Liaison Officer	
20	The proposed disposal of the Council's fee simple interest in the premises at "Viscount House", 89 Swords Road, Whitehall, Dublin 9	95 - 98
21	The proposed disposal of fee simple in Coultry Neighbourhood Centre, Ballymun, Dublin 9	99 - 100
22	Motion in the name of Councillor Noeleen Reilly	

That the Manager arranges for a Sports Expo in Ballymun where all local clubs are invited to encourage and increase participation in Clubs in the area.

23	Motion in the name of Councillor Noeleen Reilly	
----	---	--

That the Manager immediately looks at Traffic Calming measures on Balbutcher Lane beside the Rapid Build Units. Residents have resorted to making their own signs to encourage slower driving on the road.

24	Motion in the name of Councillor Andrew Montague	
----	--	--

That the City Council apply cladding to the wall on Ellenfield Park as was promised to the residents when the original works were done.

NORTH WEST AREA COMMITTEE MEETING

MINUTES

TUESDAY 18th April 2017

NWA/76/2017 Minutes of the North West Area Committee Meeting held on Tuesday 21st March 2017.

ORDER: Noted.

NWA/77/2017 Questions to the Area Manager

ORDER: Noted.

NWA/78/2017 Cabra Area Office Report, Fergus Synnott, Administrative Officer

ORDER: Noted. A Planning Information Meeting on the Phibsborough Shopping Centre Development will be held. The Cabra Report to contain more Community Information.

NWA/79/2017 Housing Cabra/Finglas Report, Derek Healy, Housing Manager

ORDER: Councillors requested a report on the delay to refurbishment of voids in Finglas/Cabra.

NWA/80/2017 Verbal Update on Feasibility Studies for St Finbarr's Court, Cecilia Lopez-Naughton, Senior Executive Architect.

ORDER: Noted.

NWA/81/2017 Verbal Update on Feasibility Studies for 61-63 Ratoath Avenue, Cecilia Lopez Naughton, Senior Executive Architect.

ORDER: Noted.

NWA/82/2017 Finglas Area Office Report, Aidan Maher, Assistant Area Manager

ORDER: Noted.

NWA/83/2017 Motion in the name of Councillor Anthony Connaghan

That this Area Committee agrees that the Scribblestown Site is not ideal for the proposed PPP scheme and we call on the Housing Manager to withdraw any support for this site. If the PPP route is followed we further call on the Housing Manager to identify an alternative site in the DCC area which would be more suitable for this development.

ORDER: This motion to be withdrawn based on meaningful consultation taking place with residents. Councillors requested to be sent the drawings for the site at the same time as residents.

NWA/84/2017 Motion in the name of Councillor David Costello

That the North West Area Committee wishes to delay the planning process for the PPP Scribblestown Development until an agreement can be made in relation to density and social mix.

ORDER: Report to Councillor.

NWA/85/2017 Motion in the name of Councillor Anthony Connaghan

That this Area Committee calls on the Manager to arrange for a full inspection of roads and footpaths in the Finglas Village area and to expedite any repairs/re-instatements necessary to bring it up to a satisfactory standard.

ORDER: A report will be requested from Road Maintenance on the permanent road reinstatements process and will be issued to all Councillors.

NWA/86/2017 Public Domain Report, John Twamley, Public Domain Officer

ORDER: A request will be sent to Bank of Ireland, Finglas Village to carry out improvements outside their premises.

NWA/87/2017 Sports & Wellbeing Partnership Report

ORDER: Noted.

NWA/88/2017 Traffic Service Requests, Status Report

ORDER: Councillors to submit pictures of traffic issues on Santry Avenue/Shanliss Way at peak times.

NWA/89/2017 Minutes of the Traffic Advisory Group (TAG) Meeting

ORDER: Noted.

NWA/90/2017 Ballymun Area Office Report, Mary Taylor, Assistant Area Manager

ORDER: Noted.

NWA/91/2017 Part 8 for Glasanaon Court, Glasanaon Park, Dublin 11 – For information purposes Cecilia Lopez-Naughton, Senior Executive Architect.

ORDER: Noted.

NWA/92/2017 Motion in the name of Councillor Noeleen Reilly

That the Area Committee supports the Ballymun Child & Family Resource Centre in converting a children's toilet to an adult's toilet. There is only one adult toilet and it just cannot cater for the number of people visiting the centre.

ORDER: Report to Councillor.

NWA/93/2017 Motion in the name of Councillor Larry O'Toole, North Central

That the Manager arranges for the trees to be pruned in Belclare Park and Green.

ORDER: Report to Councillor.

NWA/94/2017 Motion in the name of Councillor Edel Moran, North Central

That the Manager arranges repairs the potholes at the entrance of Belclare Park.

ORDER: Report to Councillor.

NWA/95/2017 Motion in the name of Councillor Greg Kelly, South Central

That the Manager arranges for the road sweeper to go into Belclare Avenue, this area hasn't been cleaned in a considerable period of time.

ORDER: Report to Councillor.

NWA Councillors:

ORDER: Councillors Noeleen Reilly, Anthony Connaghan, Emma Murphy, Paul McAuliffe, Cathleen Carney Boud, David Costello, Cieran Perry, Andrew Keegan, Seamus McGrattan, Teresa Keegan, Lord Mayor, Brendan Carr and Councillor Norma Sammon

Apologies: Councillors Aine Clancy and Andrew Montague,

Officials: Dave Dinnigan, (Area Manager), Aidan Maher (Senior Executive Officer) (Mary Taylor (Senior Executive Officer), Derek Healy (Area Housing Manager – Finglas/Cabra), Donal Barron (Area Housing Manager – Ballymun), Fergus Synnott, (Administrative Officer – Cabra), Bridget Gilbert (Senior Staff Officer), Mary Bellew (Staff Officer), John Twamley (Public Domain Officer,), Sean Callaghan (Graduate Engineer), Eoin Corrigan (Executive Engineer Traffic) Cecilia Lopez Naughton (Senior Executive Architect), Gabriella Gajdova (Executive Architect) James Nolan, (Executive Engineer PPP) and Mary Davis, (Staff Officer PPP).

**Councillor Noeleen Reilly
Chairperson**

The meeting concluded at 4.00 pm

Questions to the Area Manager

North West Area Committee

Meeting 16th May 2017

- Q.1 Councillor Paul McAuliffe**
To ask the Manager to provide bollards at the corner of (details supplied) as cars are parking on them and blocking Residents from getting out of their driveways safely.
- Q.2 Councillor Paul McAuliffe**
To ask the Manager to remove the broken glass in the Car Park on (details supplied) that is very dangerous and needs to be removed.
- Q.3 Councillor Paul McAuliffe**
To ask the Manager (details supplied) has applied for the neighbourhood watch pole to be installed and this has been approved. However she is still waiting for the Council to come and install the pole and poster. Can you please arrange same?
- Q.4 Councillor Paul McAuliffe**
To ask the Manager was (details supplied) tested for pyrite as there are cracks in the walls in the house.
- Q.5 Councillor Paul McAuliffe**
To ask the Manager there is dumping at (details supplied) that needs to be attended to.
- Q.6 Councillor Paul McAuliffe**
To ask the Manager that there is dumping on the field beside (details supplied) that needs to be removed and monitored as there are ongoing problems. Is there a possibility of putting in CCTV future down the road close to where the dumping is going. Is Dublin City Council planning on using the land across from (details supplied) as a depot?
- Q.7 Councillor Paul McAuliffe**
To ask the Manager the grass in the common area in (details supplied) is overgrown and needs to be cut.
- Q.8 Councillor Paul McAuliffe**
To ask the Manager the area beside the shops at the top of (details supplied) was supposed to be marked for parking spots and the slip be removed and levelled out. The maintenance and the up keep of the shops are also very poor and the rubbish is often left out. Can there be anything done to make sure that the shop owners keep the shop fronts tidy.
- Q.9 Councillor Paul McAuliffe**
To ask the Manager the rubbish in the shrubbery on the (details supplied) needs to be cleared there is broken glass in the shrubbery and the green along the (details supplied)
- Q.10 Councillor Noeleen Reilly**
To ask the Manager to install a Pétanque Court for boules in (details supplied).

- Q.11 Councillor Noeleen Reilly**
To ask the Manager to spray the weeds on (details supplied) and to give a timeline when this will be done.
- Q.12 Councillor Noeleen Reilly**
To ask the Manager for an update on traffic safety measures on (details supplied) between (details supplied).
- Q.13 Councillor Noeleen Reilly**
To ask the Manager for an update on works in the Playground in (details supplied) and if anything can be done to stop access to the park in the evenings and at night time. Residents living nearby are having an awful time with anti social behaviour in the area.
- Q.14 Councillor Noeleen Reilly**
To ask the Manager to remove the bin from (details supplied) on a temporary basis to see if this helps with dumping in the area.
- Q.15 Councillor Noeleen Reilly**
To ask the Manager to clear the laneways in (details supplied) and to give a date when this will be done.
- Q.16 Councillor Noeleen Reilly**
To ask the Manager to put bollards at (details supplied) to stop the cars from parking on the grass
- Q.17 Councillor Noeleen Reilly**
To ask the Manager to monitor parking at (details supplied). People are parking on the footpaths
- Q.18 Councillor Noeleen Reilly**
To ask the Manager to work with residents and arrange an event to commemorate the (details supplied) which will be in place 30 years in 2018
- Q.19 Councillor Teresa Keegan**
To ask the Manager to provide an update on the promised protected structure (details supplied) for the site to be secured and to outline what steps have been taken to compel the owners to address ongoing security and environmental issues.
- Q.20 Councillor Teresa Keegan**
To ask the Manager in respect of a proposal (details supplied) if he will provide details of the proposed maintenance of said infrastructure given its importance and in light of how poorly similar equipment has been maintained in other parts of the city.
- Q.21 Councillor Teresa Keegan**
To ask the Manager if a safety audit of the layout of a location (details supplied) can be carried out and if consideration can be given to the re-alignment of the pedestrian, cycle and traffic lanes to improve safety including the complete segregation of the pedestrian walkway from the bridge.
- Q.22 Councillor Teresa Keegan**
To ask the Manager if repairs to the road and adjoining pavements can be carried out at a location (details supplied) in light of safety concerns raised by residents.

- Q.23 Councillor Teresa Keegan**
To ask the Manager if promised repairs to a pavement can be carried out at a location without further delay (details supplied) in light of safety concerns raised by residents.
- Q.24 Councillor Teresa Keegan**
To ask the Manager if an account can be given of the serious delays that have been encountered in the commencement of a project (Details supplied) and if he will ensure that there are no further delays to this.
- Q.25 Councillor Teresa Keegan**
To ask the Manager with respect to a TAG request (Details Supplied) if he will arrange for an inspection of this junction to take place in order to address the serious concerns of residents.
- Q.26 Councillor Teresa Keegan**
To ask the Manager in light of correspondence to a TD (Details Supplied) if the Manager will arrange for appropriate signage and crossing facilities at this location in the absence of the proposed piece of infrastructure given the high volume of foot traffic and the serious concerns raised by residents.
- Q.27 Councillor Teresa Keegan**
To ask the Manager (details supplied) if he will arrange for the pruning of a tree and the repair of a path at a location (Details supplied) as the roots are pushing up the pavement.
- Q.28 Councillor Teresa Keegan**
To ask the Manager if he will arrange to have a window replaced at a residence (details supplied) as it causing difficulty for the occupant.
- Q.29 Councillor Andrew Montague**
To ask the Manager will the council erect "Children at Play" signs at the entrance to (details supplied) from the (details supplied) as there are a lot of children playing on the green space at the entrance.
- Q.30 Councillor Andrew Montague**
To ask the Manager will the council install a signalled pedestrian crossing to allow pedestrians cross here at (details supplied). When traffic is heavy it can take a long time for pedestrians to cross the road here.
- Q.31 Councillor Andrew Montague**
To ask the Manager will the council remove the graffiti (and possibly the bin) from the street furniture at the bottom of (details supplied).
- Q.32 Councillor Andrew Montague**
To ask the Manager I understand that funding has been provided to erect nets between the playing pitches and the children's playground in (details supplied). Is this project still going ahead? What is the timeframe?
- Q.33 Councillor Andrew Montague**
To ask the Manager will the council ensure the street light outside (details supplied) is fixed. It turns on and off intermittently.

- Q.34 Councillor Andrew Montague**
To ask the Manager will the council arrange to get the proper legal paperwork sorted for the (details supplied). This property has been sold to (details supplied), but without the proper legal title, there could be complications for the new owner along the line. This house was originally built on behalf of (details supplied)
- Q.35 Councillor Andrew Montague**
To ask the Manager will the council prune the tree outside (details supplied)?
- Q.36 Councillor Cieran Perry**
To ask the Manager to confirm the cause of the large flood of water outside the entrance of (details supplied) last month. This is the third time this has happened.
- Q.37 Councillor Cieran Perry**
To ask the Manager to confirm when the road repairs will be completed on (details supplied) as queried in Q.94 at the September 2016 North West Area Committee? Can he confirm realistic timelines and can he also confirm that all damaged sections of the road will be repaired?
- Q.38 Councillor Cieran Perry**
To ask the Manager to confirm that the ten Part V units in (details supplied), will be pepper potted in the development?
- Q.39 Councillor Cieran Perry**
To ask the Manager to confirm that the damaged footpath area at (details supplied), will be repaired completely rather than piecemeal?
- Q.40 Councillor Cieran Perry**
To ask the Manager to provide a copy of the (details supplied) works programme agreed for the North West Area?
- Q.41 Councillor Cieran Perry**
To ask the Manager to provide an update on the local employment statistics for the (details supplied)?
- Q.42 Councillor Cieran Perry**
To ask the Manager to provide a report on the technical difficulties with the use of modular paving at the (details supplied)?
- Q.43 Councillor Cieran Perry**
To ask the Manager to provide an update on the proposal to refurbish the playground in the (details supplied)? An outline concept plan has been developed in June 2015 but no progress appears to have been made since then.
- Q.44 Councillor Norma Sammon**
To ask the Manager to provide details of the schedule of road cleaning in the (details supplied). A resident is requesting that the Council increase the number of times the area is visited by the Council for cleaning.
- Q.45 Councillor Norma Sammon**
To ask the Manager to repair the road surface at the walkway going from (details supplied). This footpath receives significant footfall, buggies, shopping trolleys and even motor bikes. Please see photos attached.

- Q.46 Councillor Norma Sammon**
To ask the Manager to provide details of the plans to upgrade the roundabout on (details supplied) and if he will provide the plans to local community groups
- Q.47 Councillor Norma Sammon**
To ask the Manager if he will investigate the need to restricted access in the laneway at the side of (details supplied). If not, will the Council be addressing the concerns of local residents from (details supplied) regarding the increase in crime.
- Q.48 Councillor Norma Sammon**
To ask the Manager if concerns have been lodged regarding the traffic increase around (details supplied) and if the council will force the (details supplied) to open a second vehicular entrance.
- Q.49 Councillor Norma Sammon**
To ask the Manager if he will investigate the possibility of extending the deadline for housing reassessment application for (details supplied)
- Q.50 Councillor Norma Sammon**
To ask the Manager to provide details of the road maintenance works planned for 2017 in the (details supplied) areas.
- Q.51 Councillor Norma Sammon**
To ask the Manager to provide details of the works that have been carried out in conjunction with (details supplied) since the beginning of 2017. To provide details of upcoming works.
- Q.52 Councillor Norma Sammon**
To ask the Manager to provide an update on the success of CCTV and “name and shame” campaigns to tackle illegal dumping in the (details supplied).
- Q.53 Councillor Anthony Connaghan**
To ask the Manager to arrange for the footpath outside of (details supplied) to be re-instated properly. There was a leak fix here some time ago and footpath was left in a bad state.
- Q.54 Councillor Anthony Connaghan**
To ask the Manager to arrange for a clearing of all the shores in (details supplied)
- Q.55 Councillor Anthony Connaghan**
To ask the Manager to arrange for the cobble-lock outside of (details supplied) to be resurfaced as the person who lives here has a bad leg and the uneven surface is causing difficulty
- Q.56 Councillor Anthony Connaghan**
To ask the Manager to arrange for (details supplied) to be re-surfaced as it is in a poor condition.
- Q.57 Councillor Anthony Connaghan**
To ask the Manager to arrange for the provision of ramps or other traffic calming measures on the stretch of road on (details supplied) as there are incidences of speeding on this part and a child was knocked down recently.

- Q.58 Councillor Anthony Connaghan**
To ask the Manager to arrange for a maintenance inspection of (details supplied). The tenant here has reported dampness, poor flooring, Window leaks and no air vents.
- Q.59 Councillor Anthony Connaghan**
To ask the Manager to arrange for the footpath at (details supplied) to be repaired or re-instated as it is in a poor condition.
- Q.60 Councillor Anthony Connaghan**
To ask the Manager to arrange for the trees beside (details supplied) which are overgrowing into the new school to be trimmed back.
- Q.61 Councillor Anthony Connaghan**
To ask the Manager to arrange for ramps to be placed along (details supplied)
- Q.62 Councillor Anthony Connaghan**
To ask the Manager (details supplied) to arrange for the lamp-post at (details supplied) 27 Pinewood Avenue to be repainted as it is in a poor state and for the remainder along the road to be inspected for same
- Q.63 Councillor Emma Murphy**
To ask the Manager to have the windows of (details supplied) replaced.
- Q.64 Councillor Emma Murphy**
To ask the Manager if (details supplied) can be better secured to prevent motorbikes using the park.
- Q.65 Councillor Emma Murphy**
To ask the Manager if an effort can be made to have the windows for (details supplied) done before winter. The resident has stated that the windows were due at the end of 2016 and then again within the first 3 months of 2017 but now they have to wait till 2018.
- Q.66 Councillor Emma Murphy**
To ask the Manager if a 'No Dumping' sign can be placed in the lane to the rear of (details supplied)
- Q.67 Councillor Emma Murphy**
To ask the Manager if the yellow box at the junction of (details supplied) can be extended.
- Q.68 Councillor Emma Murphy**
To ask the Manager if action can be taken to tackle the parking on the footpaths on (details supplied).
- Q.69 Councillor Emma Murphy**
To ask the Manager if parking enforcement can investigate the dangerous parking at the (details supplied).

**The Chairman and Members of
North West Area Committee.**

Meeting: 16th May 2017

Item No: 3

Cabra Area Office Report

Faussagh Avenue Upgrade

The proposal to landscape the grounds on front of the church car park has, unfortunately, been rejected by the Parish Council due to concerns regarding potential anti-social behaviour. We did our best to reassure them regarding the scheme but must respect their decision. However, we will proceed with plans to plant a number of trees along the avenue initially and to upgrade the planters at the shops. We are also exploring other possibilities for enhancement.

Meanwhile, we are maintaining communications with Clúid to establish what their plans for landscaping will now be and hope to have confirmation of those shortly.

Mount Bernard Park

Park extension proposal update

Transport Infrastructure Ireland (TII) has now indicated that they are not in a position to transfer the lands adjacent to the LUAS line to DCC. The main reason given is that:

TII do not have a remit for land development (other than for roads and public transport works), so they're not allowed to allocate funding to those types of works. It has always been NRA (and now TII) policy for lands acquired under capital schemes and which are surplus to requirements, that they are disposed of in an 'undeveloped' state. In the event that TII require additional lands (in the medium to long term) to support Luas maintenance functions using these lands might be an option.

While this remains TII's position it is unlikely that a transfer of the lands will proceed. The satisfactory condition of the lands would be a significant factor to be considered in any acquisition by DCC. We had previously indicated to TII that DCC would be interested in taking these lands, subject to TII paying for the necessary remediation. We would also need an agreement on liability for any contamination related issues that might arise in the future.

I will keep the NWAC informed of any further developments.

Playground extension

The final soil testing report has now been approved by the Parks Department. Consequently, the playground contractors have been instructed to prepare their method statement and all health & safety documents - the start date may be in advance of this meeting.

Ormond Print works

I inspected this premises with Sgt. McGilloway from Cabra Station who is very familiar with activity there. The premises has been broken into and used for drinking sessions and also for storing and watering horses. These issues have been reported to Irish Water and the Control of Horses Unit, respectively.

In addition, whoever is accessing these premises used an angle grinder to remove both new and older fences connecting the premises to the canal and the new Ratoath Bridge. Again, this would seem to be to facilitate access for horses and motor bikes onto the canal bank as well as on the premises.

Derelict Section have been notified and will review the case file and inspect as the premises is acting as a focal point for a wide range of anti social behaviour that is having a serious impact on the surrounding area.

Ratoath Road Flyover

- i) In association with the Ormond Print issue above, the fencing connecting the bridge to the canal at the Ashington side has been the subject of vandalism with bolts securing the fencing being removed and replaced by locks and cable ties. This appears to be to allow access to the canal for horses and motor bikes. The issue has been referred to our Roads Department who will contact Irish Rail to try and address this situation.
- ii) Irish Rail has informed our Roads Department that they have engaged a contractor to conduct remedial works to prevent further flooding on Ballyboggan Road following heavy rain. This work is scheduled to be carried out on the June Bank holiday weekend.

Ratoath Road - Dominican Schools

Sgt. McGilloway and I attended a meeting at the convent to review the traffic issues there regarding dropping off and collection of children. All agreed that they are not easily resolvable and the convent will review their own internal traffic arrangements. Traffic Section will conduct a speed test at the bridge where it meets the road due to its proximity to Marian School and associated support units.

Royal Canal Action Day

The Action Day on April 22nd was a great success with many residential and voluntary groups participating. Groups in Rathborne, Royal Canal Park, Shandon and the Royal Canal Volunteer Group all had very successful clean ups assisted by DCC Waste management and local area offices.

Tree Planting

The tree planting programme is now complete for 2017. However, the Cabra Office has received a number of applications for planting and is working with the Parks Section and residents to assess locations that could be considered for the 2018 programme.

Carnlough Road Bottle Bank

Cabra Office received a further complaint regarding the bottle bank from Councillor Perry. This has been passed to Waste Management.

COMMUNITY & SOCIAL DEVELOPMENT

Team Dublin Clean-up

Phibsborough Tidy Towns

Held a clean-up on Easter Saturday as part of Team Dublin Clean-up and afterwards had a social gathering with music and refreshments in the Library Garden. They continue to meet once a fortnight on Saturday mornings.

The exhibition called "This must be the place" takes place in the Chocolate Factory in Kings Inn St from 2-9th May. It exhibits the work of Students and Architects from UCD working on a project called Re-imaging Phibsborough and puts forward ideas for developing the area under a number of headings.

Drumcliffe Residents and St Eithne Rd Residents

These groups also took part in the clean-ups at Easter and both greens and surrounding areas are looking well and greatly improved in appearance. Drumcliffe are particularly interested in getting young people involved and are planning to apply for funding for activities for Recreation Week which will be starting on 3rd July.

European Neighbours Day

The European Neighbours Day will be held on Friday 19th May. To mark the occasion DCC staff in conjunction with local businesses, services and groups are putting together a community event. It takes place outside the Cabra Road Shops from 12 – 2pm. This year the theme is Cabra Out & About. There will be music, refreshments, and community stands giving information on what's happening in the area and how to get involved in local activities and clubs. There is also an event being organised in the Royal Canal Community Centre in conjunction with the Housing Services Co-ordinator in the afternoon to bring people together and to get to know each other.

Royal Canal Park Community Association

The Association held their AGM on Tuesday 25th April. Jordana Corrigan stood down as secretary and was thanked for her dedication over the past number of years. The committee was elected and some new residents came forward to volunteer and join the group.

Charleville Road and Rathdown Road.

A new residents group is in the process of setting up. We look forward to supporting them in the ventures.

Plant Sales

On the week of 9th of May the environmental groups will be provided with plants, shrubs, baskets and gardening supplies to support them to hold annual plant sales and also to plant up communal areas and greens in their neighbourhoods. This also supports them in their endeavours to compete in the City Neighbourhood Competition and Tidy Towns while at the same time enhancing the environment for all to enjoy.

Altona Terrace

Their annual plant sale and coffee morning takes place this year on Saturday 6th May from 10-12 noon hosted in aid of animal rescue. It is held on the North Circular Road in one of the resident's house and garden and all the neighbours and local environmental groups are invited. It is a wonderful community affair.

Bealtaine Festival

Festival promoting creativity while ageing takes place during the month of May. To find out what events are taking place citywide go to www.bealtaine.ie. Events in the north west area include two in Glasnevin Cemetery:

- Sunday 7th May from 11-1pm – a literary tour.

- Saturday 20th May 2-5pm - a discussion on Genealogy.

For booking and more information call 01 8826550.

Groups Supported by DCC Cabra Community Staff:

Children/Young People

Cabra Community Developing Project	c/o CDP, St. Finbarr's GAA Club
Buttons Community Playgroup	Ventry Park Recreational Centre
D.7 Connect	St Vincent's Centre
Dunard Community Playgroup	c/o St. Gabriel's National School
Homestead Court Residents Association	c/o 10 Homestead Court
Navan Road Scout Group	c/o Navan Road Scout Group
Royal Canal Park Community Association	c/o 130 Meridian Court
Royal Canal Park Kids Club	Meridian Court
Royal Canal Park Parent & Toddler Group	c/o The Management Suite
St Finbarr's Playschool	Kilkieran Road
St Finbarr's Playschool	St Finbarr's Playschool
Annamoe Summer Project	Summer Project Committee (Annamoe)
Riverston Abbey Summer Project	Summer Project Committee (Riverston Abbey)
Sharing the Journey	Summer Project Committee (Marian Centre)

Educational

Ventry Park Voluntary Organisation	c/o 44 Ventry Park
Cabra East Ladies Club	6 Dingle Road
Cabra History & Folklore Project	C/o CDP, St Finbarr's GAA
Clareville Centre Ltd	c/o Clareville Centre Ltd
Dublin Circus Project Ltd.	280 Bannow Road
Dunard Youth Group	c/o 2 Dunard Walk
Bi ag Caint	c/o St Finbarr's GAA
Ceoltori Cabrach	c/o St Finbarr's GAA

Environmental

St Finbarr's Playschool	Kilkieran Road
The Ring Environmental Group	108 St. Eithne Road
Altona Terrace Residents Group	c/o 127 North Circular Road
Cabra Community College	c/o Cabra Community College CDETB
Cabra Road Residents Association	c/o 97 Cabra Road
Drumcliffe Road Residents Association	39 Drumcliffe Road
Ellesmere & Adjoining Avenues Residents Association	3 Everton Avenue
Le Cheile - St Michaels House	94a Dublin Industrial Estate
Leinster Ulster & Munster Residents Association	5 Ulster Street
Rathborne Community Association (RCA)	c/o 7 Laburnum Court
Rowan Hamilton Garden Committee	29 Rowen Hamilton Court

Royal Canal Clean Up	4 Coke Oven Cottages
St Peter's Environmental Group	1 - 5 St. Peter's Avenue
McKee Court Environmental Group	McKee Court
Kinvara Park Environmental Group	c/o 33 Kinvara Park
Shandon Residents Association	c/o Cabra Area Office

Festival/Event

Cass Residents Association	37 Skreen Road
Navan Road Community Council	c/o 13 Ashington Court
Shandon Residents Association	c/o 79 Shandon Park
Cabra Summer Festival Committee	c/o Cabra CDP/St Finbarr's
Cabra Halloween Festival Committee	c/o Cabra CDP/St Finbarr's

Informal Adult Education

Volunteers Group/Christ the King Day Centre	c/o Christ the King Day Centre
Cabra East Ladies Group	c/o The Annex Christ The King School
Clareville Centre Ltd	c/o Clareville Centre
Golden Girls Convent View Cottages	55 Carnlough Road
Green Bubble Club	c/o Green Bubble Club
Phibsboro Active Retirement Association	c/o St. Peter's Parish Office

Older Persons

Cabra Bowlers/John Paul Park	c/o Cabra CDP
Cabra Community Growth	c/o Cabra CDP, St Finbarr's GAA Club
Cabra East Ladies Club	c/o The Annex Christ the King School
Christ The King Old Folks Club	Christ The King Day Centre
Clareville Centre Ltd	c/o Clareville Centre Ltd
Clareville Court Activity Group	1 Clareville Court
Clareville Court Garden Group	69 Clareville Court
Convent View Senior Citizen Group	89 Ratoath Estate
Dunard Court Community Centre Group	69 Dunard Court
Golden Girls Convent View	55 Carnlough Road
Golden Girls Ladies Club	Christ the King Community Centre
McKee Court Tenants Association	27 McKee Court
Sancta Maria Day Centre	Kilkieran Road
Sancta Maria Ladies Club	Sancta Day Centre
Silver Surfers	553 Carnlough Road
St Finbarr's Senior Bingo Group	c/o Saint Finbarr's Court Community Room
Angels Ladies Club	Sancta Day Centre
Criost an Ri Bowls Club	Christ The King Day Centre
The Golden Girls	Convent View Centre
John Paul Senior Bowlers	Cabra Parkside
Pearl Drops Ladies Club	Christ The King Day Centre
The Golden Girls	Christ The King Day Centre
Tuesday Club	Christ The King Day Centre

Recreation

A4Sounds	c/o A4 Arts Studio & Community Education Centre Ltd.
Annamoe Youth & Environmental Group	179 Annamoe Drive
Art Group Christ the King Day Centre	c/o Christ the King Day Centre
Cabra Boxing Club	280 Bannow Road
Cabra Senior Walkers	c/o Cabra CDP, St Finbarr's GAA
Covent view Pool Club	34 Convent View Crescent
Royal Canal Clean Up	4 Coke Oven Cottages
Shandon Pitch & Putt Club	47 rere Shandon Park
St Finbarr's Art Group (Tuesday, Wednesday, Thursday)	c/o St Finbarr's Court
The Nifty Fiftys	42 Glenarriff Road

Social Inclusion

Cabra Senior Newsletter	c/o CDP, St. Finbarr's GAA Club
Cabra Seniors Men's Group	c/o Cabra CDP, St Finbarr's GAA Club
Deaf Village	Deaf Village
Cabra Men's Shed	c/o Cabra CDP, St Finbarr's GAA Club
Phibsboro Men's Shed	St Peters Court

Aidan Maher
Assistant Area Manager

**The Chairman and Members of
North West Area Committee.**

Meeting: 16th May 2017

Item No: 4

Update on the Ashtown-Pelletstown Local Area Plan 2014

The Planning and Property Development Department is undertaking a mid-term review of the Ashtown-Pelletstown Local Area Plan, which came into effect in January 2014.

The LAP states that a mid-term review report will be prepared to assess whether the objectives of the LAP are being met.

The purpose of the mid-term review is to assess whether the objectives of the plan have been or are being achieved, and to identify outstanding matters at this half-way stage of the six-year LAP. The outcome of the review will be a report to the North West Area Committee. It is anticipated that this will be in June.

The process of the mid-term review will include inputs from relevant stakeholders and nominees of residents' groups.

Cáit Ryan, Executive Planner (cait.ryan@dublincity.ie) and Jane O'Donoghue, Senior Executive Planner (Jane.ODonoghue@dublincity.ie) may be contacted in relation to the mid-term review.

John O'Hara
City Planner (A)

**The Chairman and Members of
North West Area Committee.**

Meeting: 16th May 2017

Item No: 6

Housing Matters: Cabra-Finglas Report 1st Jan – 1st May

Estate Management

	FINGLAS	CABRA
No of Anti social complaints per 1997 act Drug Related	25	8
No of Anti social complaints per 1997 act <u>Not</u> Drug Related	25	10
No of other Complaints	75	54
Total Complaints	125	72

No of Anti Social Interviews per 1997 act	24	8
No of Other Interviews	63	51
Total Interviews	87	59

No of Requests for mediation	7	6
No of Complaints referred to central unit for Action	3	0
No of Section 20 Evictions	0	0
No of excluding Orders applied for by Tenant	0	0
No of Excluding orders applied for by DCC	0	0
No of surrender of Tenancies due to Anti Social Behaviour	0	0
No of Notice to Quits sent to Central Unit	0	0
No of Court Orders Granted	0	0
No of Appeals / Judicial Reviews Challenges	0	0
No of Warrants executed (Evictions)	0	0

Housing Allocations

Category	Housing		Transfers	
	FINGLAS	CABRA	FINGLAS	CABRA
Bands 2 & 3	1	1	1	0
Medical	1	1	0	0
Welfare	2	0	1	0
Homeless	1	2	0	0
Travellers	0	0	0	0
De-tenanting	0	0	0	0
Estate Management	0	0	0	0
Maintenance Grounds	0	0	0	0
Surrendering Larger	0	0	0	0
Unable to afford	0	0	0	0
Total	5	4	2	0

Senior Citizens Allocations

Category	Housing		Transfers	
	FINGLAS	CABRA	FINGLAS	CABRA
Bands 2 & 3	3	1	3	0
Medical	2	0	0	0
Welfare	0	0	1	1
Homeless	0	0	0	0
Travellers	0	1	0	0
Estate Management	0	0	0	1

De-tenanting	0	0	3	3
Maintenance Grounds	0	0	0	0
Illegal Occupier	0	0	0	1
Surrendering Larger	0	0	0	0
Unable to afford	0	0	0	0
Financial Contribution	0	0	0	0
Total	5	2	7	6

Voids Report

To the 1st of May there are 16 vacant housing units in the Finglas Area

Address	Type of unit	Date of vacancy	Remarks
31 Abbotstown Drive	House	21/11/2016	Works in progress / On offer
201A Cappagh Road	House	10/3/2017	Works in progress / On offer
201B Cappagh Road	House	10/3/2017	Works in progress
14 Cardiffsbridge Avenue	House	07/4/2017	Works in progress
84 CardiffsBridge Road	House	03/01/2017	Works in progress / On offer
19 Casement Green	House	16/03/2017	Works in progress
10 Fairlawn Park	House	09/12/2016	Works in progress / On offer
61 Fairlawn Road	House	11/01/2017	Works in progress / On offer
49 Glenties Park	House	30/01/2017	Works in progress
80 Kildonan Avenue	House	24/03/2017	Works in progress
45 Mellowes Avenue	House	02/12/2016	Works in progress / On offer
51 McKelvey Ave	House	04/04/2017	Works in progress
32 Plunkett Road	House	03/04/2017	Works in progress
61 Ratoath Avenue	House	27/06/2016	*
63 Ratoath Avenue	House	26/07/2016	*
3 Wellmount Court	House	13/10/2016	On offer

***61-63 Ratoath Avenue**

City Architects are progressing with this development.

To the 1st of May there are 11 vacant housing units in the Cabra Area

Address	Type of unit	Date of vacancy	Remarks
273 Bannow Road	House	30/01/2017	Works in progress
332 Carnlough Road	House	12/04/2017	Works in progress
6 Fassaugh Avenue	House	20/02/2017	Works in progress
37 Fassaugh Road	House	01/12/2016	Works in progress
139 Fassaugh Road	House	24/03/2017	Works in progress
41 Glengeigh Road	House	24/03/2017	Works in progress
127 Ratoath Estate	House	13/01/2017	Works in progress / On offer
66 Saint Attracta Road	House	28/09/2016	Works in progress
297 Saint Attracta Road	House	10/03/2017	Works in progress
91 St Eithne Road	House	23/1/2017	Works in progress
127 St. Jarlath Road	House	06/02/2017	Works in progress

To the 1st of May there are 6 vacant senior citizens units in the Finglas area

Address	Type of Unit	Date of vacancy	Remarks
19 Brookville Court	1 bed	28/03/2017	Works in progress / On offer
3 Clareville Court	1 bed	20/10/2016	On offer
33 Clareville Court	Bedsit	10/01/2017	Works in progress
3 Kildonan Court	1 bed	05/02/2017	On offer
57 Mellowes Court	Bedsit	11/01/2017	Works in progress
27 Merville Court	1 bed	21/03/2017	On offer

To the 1st of May there are 6 vacant senior citizens units in the Cabra area

Address	Type of Unit	Date of vacancy	Remarks
4 Convent View Cres	Bedsit	29/09/2016	Temporary letting
6 Convent View Cres	Bedsit	17/11/2016	On offer
8 Convent View Cres	Bedsit	17/11/2016	Works in progress
28 Convent View Cres	Bedsit	13/04/2017	Works in progress

9 Dunard Court	Bedsit	26/04/2017	Works in progress
18 McKee Court	1 bed	03/03/2017	On offer

Query re timescale of refurbishment of Voids at April meeting
Please see Housing Maintenance report in your pack.

Choice Based Letting

Applicant has been selected and has been sent for Gáda vetting.

St Finbarr's Court

City Architects are progressing with this development. Eight residents remain in the complex

Rents Update

The Finglas Area Office continues to provide a rent assessment service for tenants living in the Finglas and Cabra areas.

Finglas Rent Assessment Update 1st Jan – 1st May	
Assessments	229
Permission To Resides	121
Refunds	6

Barry Area

Legal proceedings are anticipated to take place in June.

St Helena's Drive Update

Work is continuing on the construction of the 39 Rapid Delivery Houses at St. Helena's Drive. All 39 houses are now built and at different stages of first and second fix plumbing, heating, electrics and carpentry.

Work is on progress on the boundary wall at the back of Gortmore Drive.

A temporary hoarding will be erected this week extending 10 meters out into the Valley Site. This is to allow the construction of a new boundary around the new development.

The houses will be completed in the 3rd quarter and will be handed over on a phased basis.





Issues with Housing Sites/Projects in Finglas

An information session for elected representatives will be held in the Finglas Civic Offices on 31st May at 3pm in the Conference Room to discuss a report on options for addressing issues in relation to these sites/projects.

Aidan Maher
Assistant Area Manager

**The Chairman and Members of
North West Area Committee.**

Meeting: 16th May 2017

Item No: 8

Finglas Area Office Report

Barry Shops

The complex is being acquired by new owners. At a recent meeting in my office the new owners outlined their plans for upgrading the units to provide a broader range of retail activities before the year end. I subsequently visited the site with our Public Domain Officer and agreed a number of actions to be undertaken by the Area Office to support this welcome development.

Liverpool Twinning

At last September's NWAC a Motion was adopted "That the office of international relations assist the village of Finglas to establish a cultural connection/sister village relationship with an urban village in one of the following Cities currently twinned with Dublin City: San Jose, Liverpool and Barcelona."

I subsequently briefed staff from the Office of International Relations and Social Inclusion on the possible focus of a twinning and the demographics of Finglas. They then conveyed this information and the details of the Motion to the Office of the Lord Mayor of Liverpool. Unfortunately, our request became entangled in internal confusion about the intent of our request. The Office of International Relations and Social Inclusion recently renewed contact with Liverpool with the aim of reinvigorating the initiative. We await a response.

Our proposal is opportune as 2017 marks the 20th anniversary of The Twinning Agreement between Dublin and Liverpool.

Update on Kildonan Lands Project

BSM presented their draft report providing an overview of three potential options for the Kildonan site to the group chaired by Rita Burtenshaw, the Independent Facilitator, on the 4th May in the Finglas Office. The Group unanimously favoured option (c) for the following reasons:

- It maximises the use of the land for the provision of much needed homes.
- There are no large public buildings with unspecified uses.

The group also made a number of recommendations to the planners.

I wish to acknowledge the hard work and commitment of the members of the group which has enabled the process to reach this stage.

BSM will present their updated report at today's NWAC meeting. Subject to NWAC approval, it is intended to undertake a public consultation of the options during June.

COMMUNITY & SOCIAL DEVELOPMENT

Historians in residence/Grants

Dublin City Council has contracted six historians-in-residence (funded by Decade of Commemorations funding) to work with communities across the city on various history events, topics and projects.

The project will be managed by Dublin City Public Libraries in conjunction with community development teams and community groups in the DCC areas. There will be one historian allocated to each DCC area.

Dublin City Council Public Libraries have announced a Decade of Commemorations fund for history events (similar to the 1916 Rising grants scheme) and the application form and guidelines are online (there is no closing date) at:

<http://www.dublincity.ie/decadeofcommemorations>

Environmental Enhancement Project:

As part of international neighbours day, Dublin City Council's Community & Social Development Section have contacted Resident/Environmental groups with a view to providing those groups with bedding plants to enhance their local area. A number of resident groups have contacted the Community Section expressing interest in the scheme. Bedding plants will be distributed on the 18th May to groups that have registered their interest.

Finglas Older Persons Expo

Dublin City Council's Community & Social Development Team are organising an Older Persons Expo. The Aim of the Expo to give local community groups / organisations an opportunity to promote their group, share information with the local community and encourage new membership. The event will take place on:

Date: Wednesday 24th May.

Time: 12pm-3pm

Venue: WFTRA Hall, Mellowes Road, Finglas, Dublin 11.

Home school Community Liaison Wellness Fair

Dublin City Council's Community & Social Development Section financially supported the Home school Community Liaison Wellness Fair that was held in Erins Isle GAA club in April. The aim of the day was to initiate "talk" about healthy living.

Finglas Arts & Crafts Exhibition

Community and Social Development section in association with CDETB Finglas have organised a community arts and crafts exhibition as part of the 2017 Bealtaine festival. The exhibition will be held on the times and dates below. We are currently linking in with local arts groups in relation to them displaying art and crafts work or performing at the St. Canices event. This exhibition is being held in St. Canices Parochial hall.

Exhibition launch: Wednesday 31st May at 12:30pm. The launch will be followed by a performance of the Forever Young Choir in St. Canice's Church. This is a free event, all welcome.

Art exhibition opening times: Wednesday 31st May 1pm- 3pm and 6pm-8pm.

Thursday 1st June: 12pm-3pm and 5:30pm-7:15pm.

St. Canice's Church performance: Thursday 1st June at 7:30pm (invitation only). There will be performance from local writers groups, local traditional music groups, and a performance of Dermot Bolger's monologue of St. Canice.

For more information please contact the Community and Social Development Section on (01) 2225400.

Aidan Maher
Assistant Area Manager

**The Chairman and Members of
North West Area Committee.**

Meeting: 16th May 2017

Item No: 13

PUBLIC DOMAIN MAY REPORT

North West Area Complaints received via CRM

The CRM is the system used by DCC Customer Services Centre and all departments to log and track complaints. Please see details below of the number of complaints received / investigated and closed by the North West Area Office from 1st April to 30th April.

Complaint Type	Count of Incidents
Abandoned Bicycles or Trolleys	1
Community Cleanups	7
Illegal Dumping	101
Report Graffiti	7
Report Litter Offence	1
Sweep Your Street	2
Tree Maintenance	1
Weed Control	2
	122

It is important to note that a significant number of additional complaints were also investigated as all area staff pick up complaints when carrying out daily duties but due to lack of resources all complaints are not logged.

Enhancements

A decorative stone wall at the entrance to St. Canices Church, on Church St, Finglas was recently damaged when a vehicle crashed into it; it has been repaired. The repair was completed by a specialist Stone Mason, in a manner sympathetic to the original design, maintaining the character of the site. Benches at Harts Corner, situated adjacent to the planted traffic island have been repainted. New gates have been installed at the laneway at Collins Place, which should reduce the extent of dumping in this laneway and which will now give access to the laneway to facilitate periodic cleaning. New tree pits, to allow for summer planting by the Finglas Tidy Towns Group, have also been installed around the trees on

Seamus Ennis Road, outside the Credit Union. Work is also ongoing on the installation of railings at the green space between Kippure and Barnamore, with the intention of preventing motor cycles from accessing St. Helena's Road, from the green area.

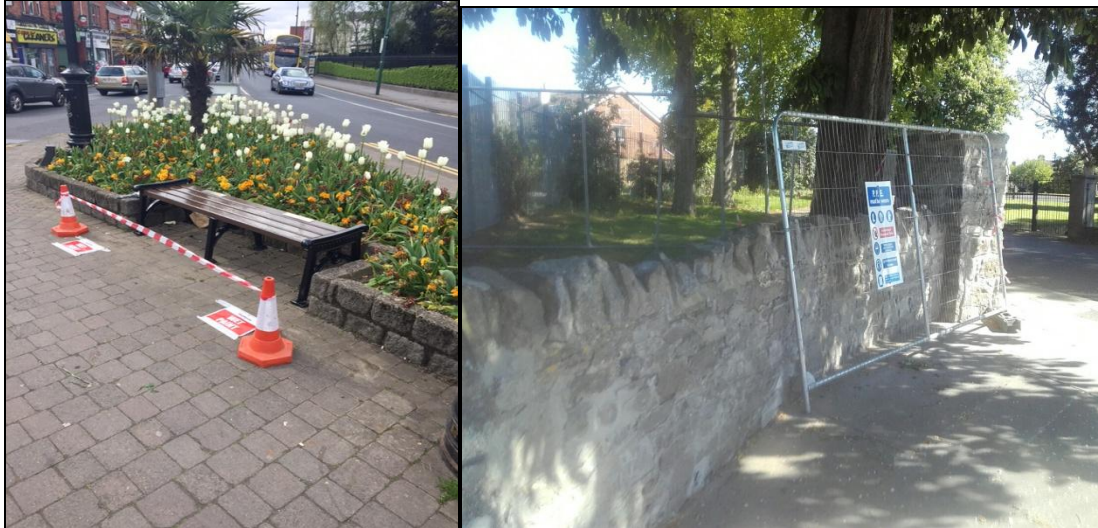

Bench painting at Harts Corner and the decorative wall recently rebuilt on Church St.

Team Dublin Clean Up 2017 Report

The 2nd Annual Team Dublin Clean Up event took place on the morning of Good Friday, April 14th. The event was well supported city wide, with residents and environmental groups in the NWA, as always, to the fore in terms of events run and numbers participating. Residents and Environmental Groups in the NWA were notified of the event by the Public Domain Team and a total of 26 groups registered to hold a cleanup event. The Public Domain Team supplied clean up equipment and support was provided after the day with bags being collected for disposal.

Excellent work was done by the environmental groups in the courts in Ballymun, where a large number of local residents turned out to further enhance their area, with weeding and edging being done. The Finglas Tidy Towns Group organised the event in Finglas Village, where a large crowd generated a festive feel, with refreshments being provided by the Public Domain Team. Good work was done by all other groups, including the Rediscovery Team on the Ballymun Road, by Phibsboro Tidy Towns on Saturday 15th and by the residents of Ballygall Senior Citizens Complex. In total over 300 bags were removed by DCC in the NWA after the weekend, providing an indication of the success of the event.



Residents from Doon Court, Ballymun and participants in Finglas Village taking part in the recent Team Dublin Clean Up event

Enforcement

Further enforcement work has been conducted by the Public Domain Team in the NWA. In response to the high level of dumping on the green space adjacent to Barry Close and Barry Drive, residents who had previously been notified of their responsibility under the Bye Laws to have a method for the disposal of their domestic waste in place were subsequently contacted and requested to provide this information. A number of Fixed Penalty Notices were issued to those residents who failed to do so. Further enforcement work has been carried out on the Cabra Road, in particular relating to breaches of the Litter Pollution Act 1997. Title searches have indicated the owners of several multi occupancy units in the area and enforcement work will be carried out in the upcoming weeks. Enforcement activity has also been recently undertaken in several other locations in the NWA.

Weed Spraying 2017

The annual weed spraying programme in the NWA is expected to commence during the week starting 15th May. Weeds on public roads and footpaths throughout the area are currently sprayed twice a year in early summer and autumn. This spraying is conducted, on behalf of DCC, by contractors Greentown Environmental, who have undertaken this work for the last number of years and have become a familiar sight, operating on quad bikes and on foot in the area. Residents who wish to report locations that require attention can contact the NWA Public Domain Team, on the email below. The NWA is scheduled for a second round of spraying in mid August.

Dog Fouling Bins

The next batch of dog fouling bins is due to be installed in the upcoming weeks, in various locations around the NWA. These bins have proved to be extremely popular with dog owners and residents alike, with demand for their installation far outstripping the available supply. Additional dog fouling bins will be installed at Park entrances, to supplement existing ones and along routes frequented by dog owners.

Subject to the further availability of bins, requests for installations at specific locations can be made to the Public Domain Team using the email address below.

Assistance to Residents Groups

The participation of residential/environmental groups in the upkeep of their roads/areas is of huge importance in making the NWA a good place in which to live and work. Increased community cohesion is also achieved by neighbors working together to enhance their location. Some notable successes have been achieved by environmental groups in the

NWA, particularly in areas previously blighted by anti social behavior, such as illegal dumping and graffiti.

The Public Domain Team is able to offer assistance to groups who wish to be involved in enhancing their area. Clean up equipment can be provided and rubbish can be collected after clean ups and disposed of. Paint and painting equipment can also be supplied to groups who wish to paint walls. Other appropriate assistance is available, based around the needs identified of the particular environmental group. New or existing groups are encouraged to contact the Public Domain Team to explore what assistance can be provided to them.

Contacting Public Domain

The NWA Public Domain Team can be contacted using the email below. This email is monitored daily and replies will be issued as soon as possible.

nwa.publicdomain@dublincity.ie

JOHN TWAMLEY

PUBLIC DOMAIN OFFICER

**The Chairman and Members of
North West Area Committee.**

Meeting: 16th May 2017

Item No: 14

Dublin City Sport and Wellbeing Partnership Report

- **Go For Life** – The Citywide Finals of the Go for Life Games takes place on Tuesday, May 16th in Ballyfermot Sports & Fitness. DCSWP Sports Officers will bring teams of older adults from their respective areas to compete in the event and try to qualify for the National Finals on June 10th in DCU. The aim is to promote physical activity and encourage social support among the participants. The programme involves three throwing games where participants throw, lob and bowl items towards a target.
- **Activities with Finglas CTC:**
A 6-week drop in soccer programme commenced with trainees from the Finglas Community Training Centre on Wednesday May 10th on the astro pitches at Finglas Sports & Fitness.

A 6-week multi sports and games session is commencing with trainees from the Finglas Community Training Centre on Tuesday May 16th in the sportshall at the Finglas Youth Resource Centre. Activities will include volleyball, uni-hockey, basketball and tug of war.
- **Afterschool Fun & Games with St. Helena Resource Centre:**
Afterschool fun & games is currently ongoing with 5th and 6th class pupils from the St. Helena Resource Centre every Tuesday and Thursday throughout May. Games will incorporate physical literacy skills including movement, agility, balance and co-ordination.
- **Scoil Chiaráin Special School:**
A six week introduction to tennis and cycling safety initiative is taking place with special needs pupils from Scoil Chiaráin during May and June. Both of these programmes are excellent for increasing pupil's co-ordination, balance and self confidence.
- **Youth Programmes - Poppintree**
A multi-sports programme will take place in a variety of venues including Poppintree Sports & Community Centre and Poppintree Park throughout May and June. These sessions are aimed at engaging youth at risk. The programme is run in partnership with local youth groups.
- **Active Flag**
A wide variety of activities is planned for local schools completing their Active Flag Award including fencing and 5-a-side soccer. Partners include local primary schools & NGB's.

- **Active School Week**
Support will be given by the DCSWP Sports Officer to local schools in Cabra to assist with Active School Week. Active school Week consists of schools becoming more active in terms of its engagement in daily physical activities. The whole school community is encouraged to get involved through walking and cycling to school, skipathons, penalty shootouts, trying new activities and physical activity homework to get the family involved!
- **National Learning Network – Soccer Sessions**
A Soccer programme for the National Learning Network is ongoing during May, aimed at engaging people experiencing mental health problems. Sessions will take place every Friday from 2pm - 3pm in Cabra Parkside Community Sports Complex.
- **Walking Football** – This programme is delivered every Tuesday from 11-1pm in Cabra Parkside Community & Sports Complex and every Thursday from 12-1pm in Poppintree Community Sports Centre. The session is delivered in partnership with the FAI. Open to men aged 55 years and older, it involves the same rules as ordinary soccer except players are not allowed to run. The aim of the programme is to provide an opportunity for men to take part in physical activity in a fun, friendly and social setting.
- **Aqua Aerobics**
An Aqua Aerobics programme takes place in Inspire Gym, Cabra, every Wednesday from 12pm - 1pm. The programme is aimed at older adults with the aim of improving water confidence, fitness and social connections. The programme is delivered in partnership with Swim Ireland and Dublin City Council and will run until June 28th.
- **Swimming Programme**
A swimming programme has been developed in partnership with Dublin City Council, Swim Ireland and the Cabra Youth Service. The programme is ongoing and will finish in early June. Young people that were previously engaged in activities organised by the DCSWP Sports Officer and the youth service were identified as requiring additional support in relation to swimming.

This need was apparent as there had been a number of incidents involving young people swimming in the local canal and jumping into the Liffey etc. Community members, agencies and young people all highlighted the need for this and as such, the programme, providing a life-long and life saving skill, was developed. It runs in Sean McDermott Street Pool on Tuesday nights from 8pm - 9pm.

- **Access Programmes (Boys & Girls)**
Badminton: Monday 4-5pm, Cabra Parkside Community Sports Complex - 10yrs+
Basketball: Tuesday 4-5pm, Cabra Parkside Community Sports Complex - 13yrs+
All sessions delivered by DCSWP Sports Officer Maz Reilly
- **Balance Matters/Falls Prevention:** Weekly functional movement classes in Poppintree Community Sports Centre with referrals from local HSE physiotherapist. These classes will run throughout the year each Wednesday from 12-1pm and 1-2pm at a cost of €3 per class.
- **Sports & Fitness Ballymun** are offering specific classes for people with back pain every Monday at 12pm (in partnership with the HSE)

- Both **Sports & Fitness Ballymun** and **Sports & Fitness Finglas** have introduced a scheme whereby homeless people currently residing in nearby hotels can access the facilities at a reduced rate to assist with their physical and mental wellbeing (in association with DePaul)

FAI/DCSWP Football Development Officers – Update

Coach Education:

Safeguarding 1 / Child Welfare Workshop – Monday May 29th, 6.30pm – 9.30pm @ Ballymun Utd Clubhouse
 Kickstart 1 (PDP1) – Saturday 3rd June, 9.30am – 5.30pm @ Ballymun Utd Clubhouse

- Schools Sessions:

Tuesday mornings

9am to 11am @ Virgin Mary Girls Primary School, Ballymun (60 Girls)
 10am to 12noon @ St. Joseph's Girls Primary School, Finglas. (50 Girls)

Thursday mornings

9am to 12noon @ NDSP Primary School, Ballymun (110 Boys/Girls)
 10am to 12noon @ St. Malachy's Primary School, Finglas (20 Boys)

- **Social inclusion:** Late Night Leagues will take place in Trinity Comprehensive School, Ballymun on Fridays from 9.00pm – 11.30pm on 19th and 26th May and 2nd and 9th June.
 They will also take place in Rivermount Hall, Finglas on Fridays until the end of May.

Boxing

- Aviva sessions will run throughout May, where Community Boxing Officers take primary school students from across the city on a tour of the Aviva Stadium (with a boxing twist!). Tours will include Irish, International and Olympic boxing memorabilia coupled with interesting and informative stories/anecdotes to inspire and educate the students.

Cricket

- The Cricket Development Officer (CDO) is liaising with DCSWP Sport Officers in the area to organise the running of cricket programmes for the coming months.
- **School-yard sessions** will continue to be delivered in the following schools:
 - St. John Bosco NS (Cabra) – Fridays 11am -12.30pm
 - St. Declan's College (Cabra) – Fridays 1pm - 2pm
 - Scoil Mobhi (Glasnevin) – Tuesdays 11am – 12.30pm

All schools mentioned above are still involved in the latter stages of the Leprechaun Cup (primary schools competition) and secondary schools cup where they compete on a weekly basis. Dates and times TBC depending on schools availability.

- A 6 week programme commenced this month in Finglas Parochial School and St. Brigid's National School. This is a joint initiative between DCSWP Sport Officer and Cricket Leinster.

- Rugby

The Metro Council Cup is an initiative set up by Leinster Rugby Development Officers to bring rugby to groups of players who have had little or no experience of playing the game. The aim is to give those players a positive experience of rugby and to further promote links to clubs in their local areas.

Now in its third year of the current format where the DCC U15 team takes part in the Metro Cup and plays the other council areas in Dublin. The team will comprise non-club players who have been introduced to the game over the past two years through participation on secondary school programmes that we have conducted in the various areas. This year the action takes place on Wednesday May 17th in Donnybrook Stadium.

Contact details

Antonia Martin, Manager, Dublin City Sport & Wellbeing Partnership:

antonia.martin@dublincity.ie

Maz Reilly, Sport Officer: marielouise.reilly@dublincity.ie

Niall Mc Donald, Sport Officer: niall.mcdonald@dublincity.ie

John McDonald, Sport Officer: john.mcdonald@dublincity.ie

Eileen Gleeson, Sport Officer: eileenb.gleeson@dublincity.ie

Jamie Wilson, FAI Soccer: jamie.wilson@fai.ie

Paul Whelan, FAI Soccer: paul.whelan@fai.ie

Oisín Fagan, Boxing: oisinfagan@gmail.com

Fintan McAllister, Cricket: fintan.mcallister@cricketleinster.ie

Stephen Maher, Rugby: stephen.maher@leinsterrugby.ie

Alan Morrin

Staff Officer

The Chairman and Members of
North West Area Committee.

Meeting: 16th May 2017

Item No: 15

Traffic Service Requests,
Status Report at 15th April 2017,
North West Area Committee Meeting, 16th May 2017

Please note that to ensure continued efficient operation of the Sharepoint database system it has become necessary to archive all completed items up to and including 31/12/15. Therefore these items are not reflected in the Status Report.

Traffic Advisory Group (TAG) Service Request Statistics

*Total TAG Requests received 01/01/17 to 15/04/17 (including duplicate requests)	109
.....of which completed	28

No. Requests received since previous report (i.e. between 16/03/16 and 15/04/17).	28
Total Requests received and currently open on Sharepoint since 1 st January, 2013 (not including secondary/duplicate requests. Number of secondary requests indicated in separate column)	396

Breakdown of Requests currently open on Sharepoint

Stage 1	4
Stage 2	316
Stage 3	2
Stage 4	57
Stage 5	17

Non TAG Service Requests Statistics

Total Non- TAG Requests received since 1 st January 2016	1039
.....of which Requests Completed	805
Total Requests currently received and open on Sharepoint since 1 st January, 2013	3722

Traffic Advisory Group Status Reports

Explanation of Stages:

- Stage 1 - Set up file, Assignment to Engineer, etc
- Stage 2 - Assessment, Site surveys, review statutory orders, etc
- Stage 3 - Consultations, with Garda, Dublin Bus, Luas, NTA, local residents / businesses, etc
- Stage 4 - Decision, TAG group, statutory orders, etc
- Stage 5 - Implementation, signs, lines, construction, signal changes, certifications, etc

Item	Ref	Road	Post-code	Topic	Request Description	Date Rec'd	SR Status	No. Secondary Requests
1	10199	GRIFFITH AVENUE (NW-EA)	D9	3 Tonne Limit	for traffic travelling westwards from Swords Road junction.	13/01/2014	Stage 4	0
2	10580	FAUSSAGH AVENUE (NW-EA)	D7	Traffic Calming	update on traffic calming request at this junction	11/02/2014	Stage 2	0
3	11377	KEMPTON WAY (NW-EA)	D7	Speed Ramps	on the road.	26/03/2014	Stage 2	1
4	11475	SKREEN ROAD (NW-EA)	D7	Traffic Lights	at the junction of Navan Road.	01/04/2014	Stage 2	1
5	11583	CHURCH AVENUE (NW-EA)	D9	Engineer Query	parking provision at the Glasnevin Educate Together National School.	03/04/2014	Stage 2	0
6	11921	MILLMOUNT AVENUE (NW-EA)	D9	Buildout		24/04/2014	Stage 4	0
7	12043	COLLINS DRIVE (NW-EA)	D11	Zebra Crossing	at the junction of Glasaree Road.	29/04/2014	Stage 2	0
8	12052	COULTRY ROAD (NW-EA)	D9	Zebra Crossing	at Gaelscoil Bhail Munna.	29/04/2014	Stage 2	1
9	12227	BALBUTCHE R LANE (NW-EA)	D11	Traffic Lights	at Carton Close/ Carton Court/Carton Road.	12/05/2014	Stage 2	0
10	12405	STORMANST OWN ROAD (NW-EA)	D11	Speed Ramps	additional ramp on the road.	12/05/2014	Stage 5	0

Item	Ref	Road	Post-code	Topic	Request Description	Date Rec'd	SR Status	No. Secondary Requests
11	12406	BALLYGALL ROAD EAST (NW-EA)	D11	Cycle Track	on both sides of the road.	12/05/2014	Stage 2	0
12	12611	SAINT HELENA'S ROAD (NW-EA)	D11	Pedestrian Crossing	south of Tesco's	26/05/2014	Stage 2	0
13	12612	SAINT HELENA'S ROAD (NW-EA)	D11	Pedestrian Crossing	at the junction of Tolka Valley Road.	26/05/2014	Stage 2	0
14	12644	SAINT PATRICK'S ROAD (NW-EA)	D9	No Left Turn (Rescind)	from St. Patrick's Road onto Whitworth Road, during morning peak.	29/05/2014	Stage 2	0
15	12646	SAINT PATRICK'S ROAD (NW-EA)	D9	Traffic Calming	on the road.	29/05/2014	Stage 2	0
16	12692	SAINT CANICES ROAD (NW-EA)	D11	Traffic Lights	request for traffic lights at the junction of St Canices Rd and Ballymun Rd	04/06/2014	Stage 2	0
17	12906	FINGLAS ROAD (NW-EA)	D11	Disabled Parking Bay (General)	and rescindment of Pay and Display Parking at the parking bay nearest the pedestrian lights to facilitate the Museum.	23/06/2014	Stage 2	0
18	13225	BLACKHORSE AVENUE (NW-EA)	D7	Traffic Lights	at the Ashtown Gate.	18/07/2014	Stage 2	0
19	13337	CLAREMONT COURT (NW-EA)	D11	Pedestrian Crossing	on Claremont Court at the junction of Finglas Road.	22/07/2014	Stage 2	0
20	13664	NAVAN ROAD (NW-EA)	D7	Bus Lane	from the Old Cabra Road to Nephin Road junction, outbound.	21/11/2016	Stage 4	0

Item	Ref	Road	Post-code	Topic	Request Description	Date Rec'd	SR Status	No. Secondary Requests
21	13970	SWORDS ROAD (NW-EA)	D9	Traffic Lights	at the exit to Elmhurst Nursing Home on Swords Road.	05/09/2014	Stage 2	0
22	14059	PINEWOOD AVENUE (NW-EA)	D11	Speed Ramps	on the road	15/09/2014	Stage 2	1
23	14544	GRIFFITH AVENUE (NW-EA)	D11	Traffic Calming	between Ballymun Road and Ballygall Road East.	06/10/2014	Stage 2	0
24	14545	BALLYBOGGAN ROAD (NW-EA)	D11	Pedestrian Refuge Island	at the junction of Ballyboggan Road and Broombridge Road.	06/10/2014	Stage 5	0
25	14626	RATOATH ROAD (NW-EA)	D7	Traffic Calming	on Cabra and Finglas ends of the road.	21/10/2014	Stage 2	1
26	14627	FAUSSAGH AVENUE (NW-EA)	D7	Traffic Calming	on the road.	21/10/2014	Stage 2	3
27	14628	NEPHIN ROAD (NW-EA)	D7	Traffic Calming	on the road.	21/10/2014	Stage 2	0
28	14630	HAZELCROFT ROAD (NW-EA)	D11	Traffic Calming	at the junction of Hazelcroft Road and Fairlawn Road.	21/10/2014	Stage 2	0
29	14631	FAIRLAWN ROAD (NW-EA)	D11	Traffic Calming	request for traffic calming on the road.	21/10/2014	Stage 2	0
30	14750	IONA CRESCENT (NW-EA)	D9	Stop Sign	'Stop' or 'Yield' Sign at the junction of Iona Villas.	13/10/2014	Stage 4	0
31	14798	RATOATH ROAD (NW-EA)	D11	Pedestrian Crossing	at the entrance to Colaiste Mhuire.	14/10/2014	Stage 4	3
32	15215	BALBUTCHER LANE (NW-EA)	D11	Pedestrian Crossing	At the Community Centre, near Carton Road.	04/11/2014	Stage 2	6
33	15231	BROOMBRIDGE ROAD (NW-EA)	D7	Double Yellow Lines	on the corners from 121/123 Broombridge Road to 353 Bannow Road.	18/11/2014	Stage 4	0

Item	Ref	Road	Post-code	Topic	Request Description	Date Rec'd	SR Status	No. Secondary Requests
34	15352	ALBERT COLLEGE LAWN (NW-EA)	D9	Pay & Display & Permit Parking	Request for parking restriction as above.	12/11/2014	Stage 2	2
35	15450	WELLMOUNT ROAD (NW-EA)	D11	Engineer Query	Erection of mirrors, and/or "Danger Vehicles Exiting" markings at main exit to St. Michael's Secondary School.	18/11/2014	Stage 2	0
36	15473	VILLA PARK GARDENS (NW-EA)	D7	Double Yellow Lines	at the footpath dishing opposite the Credit Union.	25/11/2014	Stage 2	0
37	15556	SHANTALLA ROAD (NW-EA)	D9	One-Way System	at the service road at the shops.	26/11/2014	Stage 2	0
38	15609	WHITWORTH ROAD (NW-EA)	D9	Speed Ramps	to replace the Speed Cushions with Speed Ramps.	26/11/2014	Stage 4	1
39	15649	FAUSSAGH AVENUE (NW-EA)	D7	Pedestrian Crossing	Request for pedestrian crossing at above.	01/12/2014	Stage 2	0
40	15787	SYCAMORE PARK (NW-EA)	D11	Engineer Query	to arrange for a traffic inspection at the junction of Sycamore Park and Sycamore Road.	16/12/2014	Stage 4	0
41	15789	SYCAMORE PARK (NW-EA)	D11	Engineer Query	traffic inspection at the junction of Sycamore Park and Sycamore Road.	16/12/2014	Stage 4	0
42	15846	SYCAMORE PARK (NW-EA)	D11	Pedestrian Crossing	Request for Pelican Crossing at the junction of Sycamore Park and Sycamore Road.	16/12/2014	Stage 2	0
43	15854	BALLYMUN ROAD (NW-EA)	D9	Loading Bay	at the shops, at The Grapevine Off Licence.	15/12/2014	Stage 2	0
44	15866	SHANTALLA ROAD (NW-EA)	D9	Disabled Parking Bay	outside The Haven Pharmacy, 2, Shantalla	12/12/2014	Stage 2	0

Item	Ref	Road	Post-code	Topic	Request Description	Date Rec'd	SR Status	No. Secondary Requests
				(General)	Road.			
45	15872	SAINT PATRICK'S PARADE (NW-EA)	D9	Double Yellow Lines	on the road.	18/12/2014	Stage 4	2
46	16071	OLD FINGLAS ROAD (NW-EA)	D11	School Warden	To relocate the existing School Warden to the pedestrian gate of St. Brigid's GNS.	12/01/2015	Stage 2	1
47	16169	THE RISE (NW-EA)	D9	Continuous White Line (Rescind)	at the Ballymun Road junction.	16/01/2015	Stage 2	1
48	16259	ULSTER STREET (NW-EA)	D7	Double Yellow Lines (Extend)	on Ulster Street at Connaught Street junction.	20/01/2015	Stage 2	0
49	16459	CARNLOUGH ROAD (NW-EA)	D7	Traffic Calming	on the road.	02/02/2015	Stage 2	2
50	16519	VILLA PARK GARDENS (NW-EA)	D7	Parking Prohibition	Request for Double Yellow Lines or Single Yellow Line.	04/02/2015	Stage 2	2
51	16529	CONNAUGHT STREET (NW-EA)	D7	Speed Ramps	on the road.	05/02/2015	Stage 2	0
52	16544	GLASANAON ROAD (NW-EA)	D11	Pedestrian Crossing	at Gaelscoil Ui Earcain.	05/02/2015	Stage 2	2
53	16592	IONA ROAD (NW-EA)	D9	Pay & Display & Permit Parking	On the un-named road that connects Iona Road to Lindsay Road.	05/11/2014	Stage 2	0
54	16706	MILLMOUNT AVENUE (NW-EA)	D9	Pay & Display & Permit Parking		17/02/2015	Stage 2	0
55	16726	WALSH ROAD (NW-EA)	D9	Traffic Calming	request for additional traffic calming.	16/02/2015	Stage 2	3

Item	Ref	Road	Post-code	Topic	Request Description	Date Rec'd	SR Status	No. Secondary Requests
56	16812	SKREEN ROAD (NW-EA)	D7	Parking Prohibition	on the road.	20/02/2015	Stage 4	0
57	16875	FAUSSAGH ROAD (NW-EA)	D7	Speed Ramps	on the road.	05/02/2015	Stage 2	0
58	16876	FAUSSAGH AVENUE (NW-EA)	D7	Speed Ramps	on the road.	07/02/2015	Stage 2	0
59	16889	DRUMCONDRA ROAD UPPER (NW-EA)	D9	No Right Turn	from Millmount Avenue onto Drumcondra Road.	24/02/2015	Stage 2	0
60	17007	RATOATH ROAD (NW-EA)	D7	Traffic Calming	from the roundabout at Drumcliffe Road up to Cabra cross.	02/03/2015	Stage 2	0
61	17010	SYCAMORE ROAD (NW-EA)	D11	Traffic Calming	on the road.	02/03/2015	Stage 2	0
62	17311	COOLATREE PARK (NW-EA)	D9	Speed Ramps	on the road.	23/03/2015	Stage 2	1
63	17798	FINGLAS ROAD (NW-EA)	D11	Yellow Box	inbound at the pedestrian crossing at the junction of Ballyboggan Road.	23/04/2015	Stage 2	0
64	17800	FINGLAS ROAD (NW-EA)	D11	No U Turn	outbound at the junction of Ballyboggan Road, preventing a U Turn onto the inbound lane.	23/04/2015	Stage 2	0
65	18037	GROVE WOOD (NW-EA)	D11	Traffic Calming	on the road.	07/05/2015	Stage 4	0
66	18078	COOLATREE PARK (NW-EA)	D9	Stop Sign	and rescindment of 'Yield' Sign on Coolatree Park at the junction of Coolgreena Road.	08/05/2015	Stage 2	0

Item	Ref	Road	Post-code	Topic	Request Description	Date Rec'd	SR Status	No. Secondary Requests
67	18079	COOLGREEN A ROAD (NW-EA)	D9	School Ahead Sign	on Coolgreena Road and Coolatree Park.	08/05/2015	Stage 2	0
68	18082	BEAUMONT ROAD (NW-EA)	D9	No Right Turn	from Beaumont Road onto Coolgreena Road, during morning peak.	08/05/2015	Stage 2	1
69	18154	MCKEE PARK (NW-EA)	D11		at entrance.	19/05/2015	Stage 2	0
70	18161	WALSH ROAD (NW-EA)	D9	Pedestrian Crossing	facing Griffith Park.	19/05/2015	Stage 2	3
71	18195	GLASANAON ROAD (NW-EA)	D11	Parking Prohibition	outside Nos. 154-208.	15/05/2015	Stage 4	0
72	18409	FINGLAS PLACE (NW-EA)	D11	Traffic Calming	on the road.	28/05/2015	Stage 4	1
73	18421	WILLOW PARK CRESCENT (NW-EA)	D11	Pedestrian Crossing	at the shops.	29/05/2015	Stage 2	0
74	18422	WILLOW PARK CRESCENT (NW-EA)	D11	Pedestrian Refuge Island (Rescind)	at the shops.	29/05/2015	Stage 2	0
75	18424	WILLOW PARK ROAD (NW-EA)	D11	Double Yellow Lines	at the junction of Willow Park Crescent.	29/05/2015	Stage 2	0
76	18489	BALLYGALL PARADE (NW-EA)	D11	Road Closure (Rescind)	at the western end of the road.	15/06/2015	Stage 2	0
77	18622	SAINT PATRICK'S PARADE (NW-EA)	D7	Traffic Calming	on the road.	16/06/2015	Stage 2	0
78	18624	VALEVIEW CRESCENT (NW-EA)	D11	Speed Ramps	request for speed ramps on Valeview Crescent.	16/06/2015	Stage 2	0
79	18630	SAINT PATRICK'S PARADE (NW-EA)	D9	One-Way System	on the road.	16/06/2015	Stage 2	0

Item	Ref	Road	Post-code	Topic	Request Description	Date Rec'd	SR Status	No. Secondary Requests
80	18653	GROVE WOOD (NW-EA)	D11	Speed Ramps	on the road.	08/06/2015	Stage 4	2
81	18715	FARNHAM DRIVE (NW-EA)	D11	Pedestrian Crossing	crossing to the pitches.	16/06/2015	Stage 4	0
82	18766	FITZMAURICE ROAD (NW-EA)	D11	Pedestrian Crossing	Pedestrian crossing at the shops on Fitzmaurice Rd, at junction with Ballygall Rd East.	17/06/2015	Stage 2	4
83	18767	FITZMAURICE ROAD (NW-EA)	D11	Children Crossing Sign	Children Crossing sign at shops on Fitzmaurice Rd, at junction with Ballygall Rd East.	17/06/2015	Stage 2	0
84	18831	DRUMCONDRA ROAD LOWER (NW-EA)	D9	Stop Sign	and rescindment of 'Yield' Sign on the cycle lane at the entrance to the Archbishop's House.	22/06/2015	Stage 2	0
85	18851	CABRA DRIVE (NW-EA)	D7	No Parking	request for No Parking/Double Yellow Lines on the north west corner of the entrance road to Cabra Drive from the Old Cabra Road	24/06/2015	Stage 2	0
86	18878	LINDSAY ROAD (NW-EA)	D9	Speed Ramps	Request for additional speed ramps on above road	24/06/2015	Stage 2	0
87	18913	SHANDON PARK (NW-EA)	D7		Request for Children crossing sign at above locations and also Shandon Gardens	24/06/2015	Stage 2	0
88	18957	BOTANIC ROAD NW-EA)	D9	Yellow Box	Request for yellow box at junction of the Smurfit site on Botanic Road	30/07/2015	Stage 2	0

Item	Ref	Road	Post-code	Topic	Request Description	Date Rec'd	SR Status	No. Secondary Requests
89	19020	BLACKHORSE AVENUE (NW-EA)	D7	Pedestrian Crossing	in the vicinity of Cabra Gate entrance to the Phoenix Park.	03/07/2015	Stage 2	0
90	19029	WALSH ROAD (NW-EA)	D9	Speed Ramps	Request for additional speed ramps	06/07/2015	Stage 2	1
91	19062	SAINT EITHNE ROAD (NW-EA)	D7	Speed Ramps	for ramps on road.	07/07/2015	Stage 4	0
92	19079	FINGLAS PLACE (NW-EA)	D11	Road Closure	at one end of the road.	28/05/2015	Stage 2	0
93	19152	KEMPTON AVENUE (NW-EA)	D7	Traffic Calming	at the entrance to the Kempton Estate off the Navan Road	21/07/2015	Stage 2	0
94	19155	CARNLOUGH ROAD (NW-EA)	D7	Parking Prohibition	to examine the corners of Carnlough Road for illegal parking	21/07/2015	Stage 2	0
95	19172	NAVAN ROAD (NW-EA)	D5	Single Yellow Line	in the vicinity of No. 52	21/07/2015	Stage 2	0
96	19184	PLUNKETT ROAD (NW-EA)	D11	Speed Ramps	Speed ramps requested for Plunkett Road	16/07/2015	Stage 2	0
97	19384	OFFALY ROAD (NW-EA)	D7	Double Yellow Lines	Requesting double yellow lines at the junction of Offaly Road & Dowth Avenue	24/07/2015	Stage 4	2
98	19433	DRUMCONDRA ROAD UPPER (NW-EA)	D9	Yellow Box	at the entrance to the Nest Crèche/Skylon Hotel.	30/07/2015	Stage 2	0
99	19514	CLUNE ROAD (NW-EA)	D11	Speed Ramps		05/08/2015	Stage 2	0
100	19625	DRUMCONDRA ROAD UPPER (NW-EA)	D9	Yellow Box	Outside the northern vehicular entrance to St. Patrick's College.	13/08/2015	Stage 2	0

Item	Ref	Road	Post-code	Topic	Request Description	Date Rec'd	SR Status	No. Secondary Requests
101	19666	THE THATCH ROAD (NW-EA)	D9	Yellow Box (Rescind)	Requesting that yellow lines be removed from in front of ESB Boxes across from Thatch Road	14/08/2015	Stage 2	0
102	19694	KINVARA DRIVE (NW-EA)	D7	Traffic Calming	Traffic calming measures for Kinvara Drive.	17/08/2015	Stage 2	3
103	19699	GRIFFITH DOWNS (NW-EA)	D9	Engineer Query		17/08/2015	Stage 4	4
104	19725	FINGLAS PARK (NW-EA)	D11	Traffic Calming	on the long straight section.	15/09/2015	Stage 2	2
105	19726	WOODHAZEL WAY (NW-EA)	D11	Traffic Calming	at the junction of Woodhazel Way and Woodhazel Close.	15/09/2015	Stage 2	1
106	19755	HAMPSTEAD PARK (NW-EA)	D9	Traffic Calming	Request for traffic calming measures	21/08/2015	Stage 2	0
107	19835	WALSH ROAD (NW-EA)	D9	Cul-De-Sac	Request for northern ends of above roads to be blocked off (cul de sacs to be put in place).	26/08/2015	Stage 2	0
108	19907	BOTANIC AVENUE (NW-EA)	D9	Yellow Box	Yellow Boxes for Botanic Avenue.	31/08/2015	Stage 2	0
109	19908	BOTANIC AVENUE (NW-EA)	D9	Filter Light	Filter light for junction of Saint Mobhi Rd & Botanic Ave.	31/08/2015	Stage 2	1
110	19910	RATOATH ROAD (NW-EA)	D7	School Ahead Sign	request for school ahead signs to be placed on Ratoath Road in Cabra , two schools - Saint Catherine's and Saint Dominics	01/09/2015	Stage 2	0
111	19927	LORCAN ROAD (NW-EA)	D9	Pedestrian Crossing	Install pedestrian lights at corner of Lorcan Rd.	01/09/2015	Stage 2	0

Item	Ref	Road	Post-code	Topic	Request Description	Date Rec'd	SR Status	No. Secondary Requests
112	19928	SWORDS ROAD (NW-EA)	D9	Pedestrian Crossing	Pedestrian crossing, or warning sign, at slip road from McDonalds in OMNI Centre into the Swords Rd.	01/09/2015	Stage 2	0
113	19949	RATOATH ROAD (NW-EA)	D7	Yellow Box	Request for yellow box at top end of above road at Cabra Cross	02/09/2015	Stage 2	0
114	20061	GLEBE VIEW (NW-EA)	D11	Traffic Calming	Request for traffic calming measures in Glebe View off Church Street as motorists speeding into the cul de sac causing dangerous situations for residents.	10/09/2015	Stage 2	0
115	20174	BOTANIC AVENUE (NW-EA)	D9	Traffic Calming	reps for review of traffic management on Botanic Avenue	15/09/2015	Stage 2	0
116	20185	DRUMCONDRA ROAD LOWER (NW-EA)	D9	Bus Lane	on the bridge over the Tolka, outbound.	15/09/2015	Stage 2	1
117	20189	GLENTIES DRIVE (NW-EA)	D11	Speed Ramps	on the road.	15/09/2015	Stage 4	0
118	20190	TOLKA VALLEY ROAD (NW-EA)	D11	Roundabout	at the junction of Ratoath Road.	15/09/2015	Stage 2	0
119	20256	LEINSTER STREET NORTH (NW-EA)	D7	Pay & Display & Permit Parking (extension of area)		17/09/2015	Stage 4	0
120	20278	SILLOGE ROAD (NW-EA)	D11	Pedestrian Crossing	Request for pedestrian crossing at Holy Spirit School	21/09/2015	Stage 2	0

Item	Ref	Road	Post-code	Topic	Request Description	Date Rec'd	SR Status	No. Secondary Requests
121	20317	DINGLE ROAD (NW-EA)	D7	Traffic Calming	Request for speed ramps or traffic calming measures on Dingle Road	21/09/2015	Stage 2	0
122	20379	BALLYMUN ROAD (NW-EA)	D9	Disabled Parking Bay (General)	Request by Cllr to have a disabled parking bay outside the Supervalu shop on Ballymun Road.	23/09/2015	Stage 2	0
123	20385	CABRA GROVE (NW-EA)	D7	Double Yellow Lines	along the left-hand side as you enter from Cabra Road, up as far as the curve.	24/09/2015	Stage 2	0
124	20494	DANE ROAD (NW-EA)	D11	Speed Ramps	Request for speed ramps on St Josephs Way, off Dane Road, beside Cairn Court	30/09/2015	Stage 2	0
125	20516	SHANGAN AVENUE (NW-EA)	D11	Double Yellow Lines	Request for double yellow lines around the Whiteacre Park Estate	01/10/2015	Stage 2	0
126	20522	GLASANAON ROAD (NW-EA)	D11	Double Yellow Lines	Request for double yellow lines outside Gaelscoil ui Earcain	01/10/2015	Stage 2	0
127	20568	PHIBSBOROUGH ROAD (NW-EA)	D7	Yellow Box	Request for yellow box at entrance to Bective Square Apartment complex at junction with Phibsborough road	05/10/2015	Stage 2	0
128	20630	SCRIBBLESTOWN AVENUE (NW-EA)	D11	Traffic Calming	within the Scribblestown Estate.	20/10/2015	Stage 2	4
129	20677	THE THATCH ROAD (NW-EA)	D9	Double Yellow Lines	at entrance beside No.13.	20/10/2015	Stage 2	0

Item	Ref	Road	Post-code	Topic	Request Description	Date Rec'd	SR Status	No. Secondary Requests
130	20685	VALLEY PARK ROAD (NW-EA)	D11	Speed Ramps	at entrance.	20/10/2015	Stage 2	0
131	20704	DELVILLE ROAD (NW-EA)	D11	Stop Sign	at the junction of Delville Road and St Pappin's Road.	20/10/2015	Stage 4	0
132	20706	RATOATH ROAD (NW-EA)	D7	Right Turn Filter Light	from Ratoath Road onto Navan Road.	20/10/2015	Stage 2	1
133	20707	BOTANIC AVENUE (NW-EA)	D9	Double Yellow Lines	at the junction of Botanic Avenue with St. Ita's Terrace, Botanic Road.	20/10/2015	Stage 2	0
134	20729	KINVARA AVENUE (NW-EA)	D8	Pedestrian Crossing	Request from area office from Navan Rd community council for pedestrian lights at Kinvara Avenue and Ashtown Grove.	12/10/2015	Stage 2	0
135	20739	ASHTOWN GROVE (NW-EA)	D7	Pedestrian Crossing	at the junction of Ashtown Grove and Navan Road.	09/10/2015	Stage 2	0
136	20794	COLLINS AVENUE (NW-EA)	D11	Yellow Box	to review traffic at the pedestrian lights at junction of Collins Avenue and Ballymun Road.	20/10/2015	Stage 2	0
137	20848	PARKGATE STREET (NW-EA)	D8	Loading Bay	Outside 25 Parkgate Street, Dublin 8.	16/10/2015	Stage 2	0
138	20861	HOME FARM ROAD (NW-EA)	D3	Cycle Track	New Cycle Track between Homefarm Road and Griffith Avenue. Cycle track does not leave enough room for pedestrians	14/10/2015	Stage 2	0

Item	Ref	Road	Post-code	Topic	Request Description	Date Rec'd	SR Status	No. Secondary Requests
139	20868	CONNAUGHT STREET (NW-EA)	D7	Disabled Parking Bay (Residential)	To determine whether the road is high demand or not in relation to the level of parking occupancy for the provision of a bay outside No. 37. Pay and Display and Permit Parking will have to be rescinded.	19/10/2015	Stage 2	0
140	20963	FERGUSON ROAD (NW-EA)	D9	Speed Ramps (Rescind)	on the road.	20/10/2015	Stage 2	0
141	20991	NAVAN ROAD (NW-EA)	D7	No Parking	Request to disallow parking outside crèche at 351a Navan Rd.	22/10/2015	Stage 2	0
142	20995	SAINT MARGARET'S ROAD (NW-EA)	D11	Pedestrian Crossing	Upgrade of the roundabout at LIDL and if the upgrade is warranted.	19/10/2015	Stage 2	0
143	21057	COLLINS AVENUE (NW-EA)	D9	Yellow Box	at the exit of Whitehall Church at Collins Avenue.	27/10/2015	Stage 2	1
144	21076	MANNIX ROAD (NW-EA)	D9	Cul-De-Sac	To make Mannix Road a Cul-de-Sac, between the rear entrance to Mannix Road and the Hollybank Road entrance.	28/10/2015	Stage 2	0
145	21094	GLASNEVIN AVENUE (NW-EA)	D9	Pedestrian Crossing	To review the Pedestrian Crossings at the junction of Glasnevin Avenue/Collins Avenue/Ballymun Road.	28/10/2015	Stage 2	0
146	21096	ALBERT COLLEGE PARK (NW-EA)	D9	Double Yellow Lines	at the junction of Collins Avenue Extension.	28/10/2015	Stage 2	0

Item	Ref	Road	Post-code	Topic	Request Description	Date Rec'd	SR Status	No. Secondary Requests
147	21097	OLD FINGLAS ROAD (NW-EA)	D11	School Warden	at St. Mary's Faith Secondary School.	28/10/2015	Stage 2	0
148	21100	SAINT PAPPIN ROAD (NW-EA)	D11	Parking Prohibition	at the western junction of Dean Swift Road and St. Pappin's Road.	28/10/2015	Stage 2	0
149	21107	OLD CABRA ROAD (NW-EA)	D7	Traffic Calming	To review the traffic calming measures on the road.	27/10/2015	Stage 2	0
150	21181	OLD FINGLAS ROAD (NW-EA)	D11	Pedestrian Crossing	at the entrance to St. Mary's School.	29/10/2015	Stage 2	2
151	27737	DRUMCONDRA ROAD UPPER (NW-EA)	D1		on Drumcondra Road Upper at the junction with The Village.	17/11/2015	Stage 2	0
152	27740	YELLOW ROAD (NW-EA)	D9	Stop Sign	on Yellow Road at the junction with The Thatch Road.	17/11/2015	Stage 4	0
153	27741	SANTRY AVENUE (NW-EA)	D9	Traffic Lights	at the junction of Santry Avenue and Forrestwood Estate.	17/11/2015	Stage 2	0
154	27754	BELCLARE AVENUE (NW-EA)	D11	Traffic Calming	at No. 13.	10/11/2015	Stage 2	0
155	27780	PROSPECT WAY (NW-EA)	D9	Bus Lane	Relocate the Bus Lane to the middle lane.	10/11/2015	Stage 2	0
156	27825	RIVER ROAD (NW-EA)	D15	Double Yellow Lines	on the bend.	12/11/2015	Stage 2	1
157	27921	FINGLAS ROAD (NW-EA)	D11	Electric Car Bay	Finglas road north of junction with Tower View Cottages, opposite cemetery, the 2nd and 3rd spaces.	19/11/2015	Stage 2	0

Item	Ref	Road	Post-code	Topic	Request Description	Date Rec'd	SR Status	No. Secondary Requests
158	28005	PROSPECT ROAD (NW-EA)	D9	Yellow Box	on Prospect Road/Finglas Road, having crossed from Lindsay Road.	23/11/2015	Stage 4	1
159	28133	BOTANIC ROAD NW-EA)	D9	No Right Turn	from Botanic Avenue onto St. Mobhi Road, during evening peak hours.	26/11/2015	Stage 2	0
160	28152	HOME FARM ROAD (NW-EA)	D9	Loading Bay	outside Homefarm Pharmacy, No. 45a.	24/11/2015	Stage 2	0
161	28154	HOME FARM ROAD (NW-EA)	D9	Disabled Parking Bay (General)	outside Homefarm Pharmacy, No. 45a.	24/11/2015	Stage 2	3
162	28158	MCKEE AVENUE (NW-EA)	D11	Double Yellow Lines (Extend)	on either side of the entrance to Heath Square.	26/11/2015	Stage 2	0
163	28197	CONYNGHAM ROAD (NW-EA)	D8	Parking Prohibition	and rescindment of Pay and Display Parking along Longmeadow Apartments.	30/11/2015	Stage 2	1
164	28341	LINDSAY GROVE (NW-EA)	D9	Parking Prohibition	at the Prospect Road, end of the road.	17/11/2015	Stage 2	0
165	28367	GROVE PARK CRESCENT (NW-EA)	D10	Speed Ramps	on the road.	15/12/2015	Stage 2	0
166	28368	GROVE PARK DRIVE (NW-EA)	D11	Speed Ramps	on the road.	15/12/2015	Stage 2	0
167	28369	SHANOWEN CRESCENT (NW-EA)	D9	Parking Prohibition	in the cul-de-sac.	15/12/2015	Stage 2	0
168	28370	GALLAUN ROAD (NW-EA)	D11	Stop Sign	Stop/Yield sign at the back of Poppintree Sports Complex and Gallaun Road.	15/12/2015	Stage 2	0

Item	Ref	Road	Post-code	Topic	Request Description	Date Rec'd	SR Status	No. Secondary Requests
169	28374	GLASNEVIN AVENUE (NW-EA)	D9	Continuous White Line	from the junction with Ballymun Road as far as 30/32.	15/12/2015	Stage 2	0
170	28375	LORCAN AVENUE (NW-EA)	D9	Double Yellow Lines	at the junction of Lorcan Avenue and Lorcan Park.	15/12/2015	Stage 2	0
171	28376	LORCAN AVENUE (NW-EA)	D9	Yield Sign	at the junction of Lorcan Avenue and Lorcan Park.	15/12/2015	Stage 2	0
172	28382	KILSHANE ROAD (NW-EA)	D11	Traffic Calming	on the road, adjacent to No. 11.	07/12/2015	Stage 2	1
173	28419	FINGLAS ROAD (NW-EA)	D11	Pedestrian Crossing	Pedestrian Crossing/improve traffic flow at Finglas Road roundabout and Finglas Village junction.	15/12/2015	Stage 2	0
174	28517	GLENTIES PARK (NW-EA)	D11	Pedestrian Crossing	On Glenties Park at Cardiffsbridge Road junction.	15/12/2015	Stage 2	0
175	28632	SHANLISS ROAD (NW-EA)	D9	Traffic Calming		11/01/2016	Stage 2	1
176	28633	BALBUTCHER LANE (NW-EA)	D11	Traffic Calming	from the old Shopping Centre to Poppintree.	11/01/2016	Stage 2	0
177	28729	DALCASSIAN DOWNS (NW-EA)	D11	Double Yellow Lines	and rescindment of Pay and Display and Permit Parking opposite Nos. 11-14.	07/01/2016	Stage 2	0
178	28752	BOTANIC ROAD (NW-EA)	D9	Traffic Lights	To move the traffic lights on Botanic Road to just before the Lindsay Road junction.	18/11/2015	Stage 2	0
179	28753	BOTANIC ROAD (NW-EA)	D9	Speed Ramps	on Botanic Road just before the Lindsay Road junction.	18/11/2015	Stage 2	0

Item	Ref	Road	Post-code	Topic	Request Description	Date Rec'd	SR Status	No. Secondary Requests
180	28795	COLLINS AVENUE (NW-EA)	D9	Engineer Query	To review of the junction turning left from Collins Avenue West onto Swords Road.	11/01/2016	Stage 2	0
181	28809	ASHINGTON AVENUE (NW-EA)	D7	Pedestrian Crossing	on the road.	19/01/2016	Stage 2	0
182	28815	BLACKHORSE AVENUE (NW-EA)	D7	Parking Prohibition	various as part of Blackhorse Avenue Scheme.	12/01/2016	Stage 5	1
183	28816	DALCASSIAN DOWNS (NW-EA)	D11	Pay & Display & Permit Parking	Request to review the Pay and Display and Permit Parking opposite Nos. 12-14.	11/01/2016	Stage 2	0
184	29011	SHANDON PARK (NW-EA)	D7	Double Yellow Lines (Extend)	from the Shandon Gardens junction.	18/01/2016	Stage 2	-1
185	29016	WOODHAZEL CLOSE (NW-EA)	D9	Parking Prohibition	Parking prohibitions for Woodhazel Close, Ballymun.	16/01/2016	Stage 2	1
186	29049	KEMPTON WAY (NW-EA)	D7	Double Yellow Lines (Extend)	on Kempton Way.	19/01/2016	Stage 2	0
187	29062	BOTANIC AVENUE (NW-EA)	D9	Disabled Parking Bay (Rescind Residential)	outside No. 88 and replace with Pay and Display and Permit Parking.	20/01/2016	Stage 2	0
188	29156	LEINSTER STREET NORTH (NW-EA)	D7	Double Yellow Lines	At No. 1, from the pay and display and permit parking to the junction of the laneway.	28/01/2016	Stage 5	0
189	29208	SWORDS ROAD (NW-EA)	D9	No Left Turn	from Swords Road onto Collins Avenue.	01/02/2016	Stage 4	0
190	29302	MARLBOROUGH MEWS (NW-EA)	D7	Parking Prohibition	on the road.	01/02/2016	Stage 2	0

Item	Ref	Road	Post-code	Topic	Request Description	Date Rec'd	SR Status	No. Secondary Requests
191	29372	DUNARD ROAD (NW-EA)	D7	Double Yellow Lines	DYs for Dunard Rd, close to Tesco's, on the corners heading into the cul-de-sac at Nos. 78 & 50.	04/02/2016	Stage 2	0
192	29410	CONNAUGHT STREET (NW-EA)	D7	Double Yellow Lines	Request for double yellow lines on laneway at rear of above roads.	05/02/2016	Stage 2	0
193	29432	PINEWOOD AVENUE (NW-EA)	D11	Speed Ramps	outside 25/27	16/02/2016	Stage 2	0
194	29524	LARKHILL ROAD (NW-EA)	D9	Speed Ramps		17/02/2016	Stage 2	0
195	29527	BALLYMUN ROAD (NW-EA)	D11	Yellow Box	Yellow box at above junction	09/02/2016	Stage 2	0
196	29837	RATOATH ROAD (NW-EA)	D7	Parking Prohibition	Parking restrictions outside no.287 Ratoath Road	19/02/2016	Stage 2	0
197	29848	DALCASSIAN DOWNS (NW-EA)	D11	Double Yellow Lines	Double yellow lines outside 63 Dalcassian Downs.	22/02/2016	Stage 4	0
198	29882	SHANTALLA DRIVE (NW-EA)	D9	Speed Ramps	Speed ramps on the road	23/02/2016	Stage 2	0
199	29965	SAINT HELENA'S ROAD (NW-EA)	D11	Double Yellow Lines	from the junction of St. Helena's Drive to the rear entrance to Tesco Clearwater.	26/02/2016	Stage 2	0
200	29969	TOLKA VALLEY ROAD (NW-EA)	D11	Pedestrian Crossing	for safe crossing for disabled people to cross the disabled entrance to Tolka Valley Park.	29/02/2016	Stage 2	0
201	30002	BALLYGALL ROAD WEST (NW-EA)	D11	Yellow Box	Request for yellow box at above junction.	29/02/2016	Stage 2	0
202	30003	DALCASSIAN DOWNS (NW-EA)	D11	Double Yellow Lines	outside the houses.	29/02/2016	Stage 2	0

Item	Ref	Road	Post-code	Topic	Request Description	Date Rec'd	SR Status	No. Secondary Requests
203	30046	SAINT PATRICK'S PARADE (NW-EA)	D9	Pay & Display & Permit Parking	on the road, from St. Patrick's Road to St. Columba's Road Upper.	02/03/2016	Stage 2	1
204	30063	NORE ROAD (NW-EA)	D11	Double Yellow Lines	Double yellow lines on above road outside SPACE SELF STORAGE premises	03/03/2016	Stage 4	0
205	30098	COLLINS AVENUE (NW-EA)	D9	Double Yellow Lines (Extend)	from the junction of The Thatch Road.	04/03/2016	Stage 2	0
206	30099	GRIFFITH AVENUE (NW-EA)	D11	Yellow Box	at the junction of Ballygall Road East.	04/03/2016	Stage 2	0
207	30111	FITZMAURICE ROAD (NW-EA)	D11	Pedestrian Crossing	outside the Credit Union	04/03/2016	Stage 2	2
208	30128	COLLINS AVENUE (NW-EA)	D9	Double Yellow Lines	at the turning circle at No. 451.	07/03/2016	Stage 5	2
209	30178	ALBERT COLLEGE PARK (NW-EA)	D9	Single Yellow Line	outside Nos. 12A – 12C.	08/03/2016	Stage 2	2
210	30232	SCRIBBLESTOWN LANE (NW-EA)	D11	Children Crossing Sign	on Scribblestown Lane.	15/03/2016	Stage 4	0
211	30260	LARKHILL ROAD (NW-EA)	D9	One-Way System	Weekdays, at school collection and drop off times.	10/03/2016	Stage 2	0
212	30313	SAINT PAPPIN ROAD (NW-EA)	D11	Traffic Lights	at the junction of Stormanstown Road.	15/03/2016	Stage 2	0
213	30366	SAINT JOSEPH'S WAY (NW-EA)	D11	Traffic Calming	Ramps or traffic calming	18/03/2016	Stage 2	0
2141	30630	SHANOWEN ROAD (NW-EA)	D9	Double Yellow Lines	on either side of the entrance to Shanowen Hall Student Residence.	07/04/2016	Stage 2	0

Item	Ref	Road	Post-code	Topic	Request Description	Date Rec'd	SR Status	No. Secondary Requests
215	30685	CEDARWOOD PARK (NW-EA)	D11	Children Crossing Sign	on the road.	19/04/2016	Stage 4	0
216	30686	BALBUTCHER LANE (NW-EA)	D11	Traffic Calming	beside the new Rapid built homes at Baile Na Laochra	19/04/2016	Stage 2	0
217	30708	WELLMOUNT ROAD (NW-EA)	D11	Pay & Display Parking	on the road N2 junction end.	19/04/2016	Stage 2	0
218	30768	DEAN SWIFT ROAD (NW-EA)	D11	Children Crossing Sign	on the road.	12/04/2016	Stage 4	0
219	30807	MARLBOROUGH ROAD (NW-EA)	D7	Pay & Display & Permit Parking	on the road.	14/04/2016	Stage 2	0
220	30826	BALBUTCHER LANE (NW-EA)	D11	Pedestrian Crossing	At Baile Na Laochra (Modular homes site)	16/04/2016	Stage 2	0
221	30830	SHANLISS WAY (NW-EA)	D11	Speed Ramps	between the Santry Lane end and the pedestrian entrance to Ballymun Estate.	16/04/2016	Stage 2	1
222	30870	CRANOGUE ROAD (NW-EA)	D11	Yield Sign	at the junction of Cranogue Terrace.	19/04/2016	Stage 4	0
223	30950	POPPINTREE CRESCENT (NW-EA)	D11	Traffic Calming	on the road at above location	22/04/2016	Stage 2	0
224	30993	RATHLIN ROAD (NW-EA)	D9	Double Yellow Lines	on the road opposite the entrance to 400 Griffith Avenue	25/04/2016	Stage 2	0
225	30994	WILLOW PARK AVENUE (NW-EA)	D11	Speed Ramps	on the road.	25/04/2016	Stage 2	0
226	31017	BARRY AVENUE (NW-EA)	D11	School Ahead Sign	on the road	26/04/2016	Stage 2	1
227	31113	ALBERT COLLEGE PARK (NW-EA)	D9	Continuous White Line	(or Double Yellow Lines) <u>on the two bends.</u>	29/04/2016	Stage 2	2

Item	Ref	Road	Post-code	Topic	Request Description	Date Rec'd	SR Status	No. Secondary Requests
228	31157	HAMPSTEAD COURT (NW-EA)	D9	Double Yellow Lines (Extend)	Request for extension of DYL's outside no 42, location is opposite the Community Centre, at entrance to apartments.	05/05/2016	Stage 2	0
229	31200	BALLYGALL ROAD WEST (NW-EA)	D11	Double Yellow Lines (Extend)	at the junction of Ballygall Road West and Main Street Finglas.	09/05/2016	Stage 2	0
230	31201	ABBOTSTOWN ROAD (NW-EA)	D11	Traffic Calming	on the road.	09/05/2016	Stage 2	1
231	31206	ALBERT COLLEGE PARK (NW-EA)	D9	Double Yellow Lines	on one side of the road.	17/05/2016	Stage 2	0
232	31209	WALNUT LAWN (NW-EA)	D9	Double Yellow Lines	opposite No. 11.	17/05/2016	Stage 2	0
233	31210	CABRA ROAD (NW-EA)	D7	Yellow Box	at the junction of Cabra Road and Dowth Avenue.	17/05/2016	Stage 2	0
234	31216	BALBUTCHER LANE (NW-EA)	D11	Yellow Box	at the junction of Carton Drive and Balbutcher Lane.	17/05/2016	Stage 2	0
235	31257	RATOATH ROAD (NW-EA)	D7	Bus Stop Marking	at Dublin Bus No. 7027.	06/05/2016	Stage 2	0
236	31350	SHANTALLA ROAD (NW-EA)	D9	Stop Sign	at the roundabout at the junction of Shantalla Road and Swords Road.	09/05/2016	Stage 4	0
237	31354	ALBERT COLLEGE DRIVE (NW-EA)	D9	Double Yellow Lines	at Albert College Court.	09/05/2016	Stage 2	0
238	31364	MAGENTA CRESCENT (NW-EA)	D9	Traffic Calming	traffic calming measures at the entrance	16/05/2016	Stage 2	0

Item	Ref	Road	Post-code	Topic	Request Description	Date Rec'd	SR Status	No. Secondary Requests
239	31378	SAINT CLEMENTS ROAD (NW-EA)	D9	Double Yellow Lines (Rescind)	from outside No. 1.	17/05/2016	Stage 4	0
240	31415	FAUSSAGH AVENUE (NW-EA)	D7	Parking Prohibition	on the road.	17/05/2016	Stage 5	0
241	31514	SHANOWEN ROAD (NW-EA)	D9	Yellow Box	at the entrance to Shanowen Hall Student Residence	07/04/2016	Stage 2	0
242	31555	CABRA ROAD (NW-EA)	D7	Double Yellow Lines	across entrance to property No. 123	25/05/2016	Stage 2	0
243	31715	SHANOWEN ROAD (NW-EA)	D9	Double Yellow Lines	at junction of Shanowen Avenue.	31/05/2016	Stage 2	0
244	31717	SHANOWEN CRESCENT (NW-EA)	D9	Double Yellow Lines	at the entrance	31/05/2016	Stage 2	0
245	31760	BALLYGALL PARADE (NW-EA)	D9	Speed Ramps	on above road	03/06/2016	Stage 2	0
246	31910	BALLYMUN ROAD (NW-EA)	D11	Double Yellow Lines	between house number 18 and 20	10/06/2016	Stage 2	0
247	32074	SHANOWEN ROAD (NW-EA)	D9	Double Yellow Lines	at Shanowen Hall Apartments.	20/06/2016	Stage 2	0
248	32108	POPPINTREE CRESCENT (NW-EA)	D11	Traffic Calming	on Poppintree Crescent and Belclare Avenue.	13/06/2016	Stage 2	0
249	32174	CHURCH AVENUE (NW-EA)	D9	Parking Prohibition	at St Mobhi Church, Church Avenue, Ballymun.	21/06/2016	Stage 2	0
250	32352	DRUMCONDRA ROAD UPPER (NW-EA)	D9	Double Yellow Lines	Outside The Nest Crèche 27 Upper Drumcondra Rd	27/06/2016	Stage 2	0
251	32356	WELLMOUNT ROAD (NW-EA)	D11		Request to review vehicle entrance to St Michaels School in respect of approaching cyclists.	28/06/2016	Stage 2	0

Item	Ref	Road	Post-code	Topic	Request Description	Date Rec'd	SR Status	No. Secondary Requests
252	32375	SAINT ITA'S ROAD (NW-EA)	D9	Disabled Parking Bay (Residential)	outside No.14	29/06/2016	Stage 2	0
253	32440	SHANDON PARK (NW-EA)	D7	Double Yellow Lines	Request for DYL's outside 114 Shandon Park (request also in for repainting of existing ones at side of house SR 32438)	01/07/2016	Stage 2	0
254	32454	LEIX ROAD (NW-EA)	D7	Engineer Query	Request for engineer to look at putting rush hour restrictions at the above area, and also for engineer to put plans for increased parking into the area for when the LUAS station opens.	04/07/2016	Stage 2	0
255	32455	DOWTH AVENUE (NW-EA)	D7	Parking Prohibition	Request for parking restrictions at above road due to issues for the local residents as a result of illegal parking, and no parking restrictions.	04/07/2016	Stage 2	1
256	32458	DOWTH AVENUE (NW-EA)	D7	Speed Ramps	Request for speed ramps for above road as cars using it as a rat run.	04/07/2016	Stage 2	0
257	32523	MARLBOROUGH ROAD (NW-EA)	D7	Continuous White Line (Rescind)	on Marlborough Road at junction with North Circular Road	05/07/2016	Stage 2	0
258	32555	CREMORE HEIGHTS (NW-EA)	D11	Double Yellow Lines	at 1-29 on the church side of the road.	19/07/2016	Stage 2	2

Item	Ref	Road	Post-code	Topic	Request Description	Date Rec'd	SR Status	No. Secondary Requests
259	32578	ARRAN ROAD (NW-EA)	D9	Disabled Parking Bay (Residential)	outside No. 28. Installation of bay <u>ON HOLD</u>	07/07/2016	Stage 5	0
260	32668	KEMPTON AVENUE (NW-EA)	D7	Double Yellow Lines	in the estate	12/07/2016	Stage 4	1
261	32696	SHANOWEN ROAD (NW-EA)	D9	Double Yellow Lines	Outside number 190	13/07/2016	Stage 2	0
262	32698	HOME FARM PARK (NW-EA)	D9	Double Yellow Lines	Double yellow lines at entrance to Home Farm Park	13/07/2016	Stage 4	1
263	32714	COOLGARIFF ROAD (NW-EA)	D9	No Right Turn	Request to ban a right turn from Coolgariff Rd on to Coolatree Park.	13/07/2016	Stage 2	0
264	32796	FLEMING ROAD (NW-EA)	D9	Double Yellow Lines	at top and bottom of road as cars park too close to junction.	18/07/2016	Stage 2	0
265	32986	PROSPECT SQUARE (NW-EA)	D9	Double Yellow Lines	Committee requests that DYLS be marked around bend of Prospect Sq. and St. Teresa Road	28/07/2016	Stage 2	2
266	33054	SWORDS ROAD (NW-EA)	D9	Pedestrian Crossing	at Comet Pub	28/07/2016	Stage 2	0
267	33058	ANNALY ROAD (NW-EA)	D7	Double Yellow Lines	request DYLS from stop sign .	29/07/2016	Stage 4	0
268	33081	GLASANAON ROAD (NW-EA)	D11	Double Yellow Lines	above road	02/08/2016	Stage 2	0
269	33149	WELLMOUNT ROAD (NW-EA)	D11	Pedestrian Crossing	Request for pedestrian crossing	04/08/2016	Stage 2	0
270	33153	TOLKA COTTAGES (NW-EA)	D11	Disabled Parking Bay (Residential)	opposite property No. 12.	08/08/2016	Stage 2	0

Item	Ref	Road	Post-code	Topic	Request Description	Date Rec'd	SR Status	No. Secondary Requests
271	33281	CRAWFORD AVENUE (NW-EA)	D11	Double Yellow Lines	request for DYLS outside St. Columba's NS	16/08/2016	Stage 5	1
272	33282	SWORDS ROAD (NW-EA)	D9	Pedestrian Crossing	Extra crossing.	16/08/2016	Stage 2	0
273	33309	SWILLY ROAD (NW-EA)	D7	Traffic Calming	residents of above roads would like to see some kind of traffic measure at junction	17/08/2016	Stage 2	0
274	33310	BALBUTCHER LANE (NW-EA)	D11		request for traffic calming measures at corner of above roads	17/08/2016	Stage 2	0
275	33312	KINVARA AVENUE (NW-EA)	D3	Right Turn Filter Light	from Kinvara Avenue, see comments on previous SR2010.	17/08/2016	Stage 4	0
276	33343	CHURCH AVENUE (NW-EA)	D9	Double Yellow Lines	DYLS for Church Avenue, between 11 Church Ave and 2 Ballymun Rd.	18/08/2016	Stage 2	0
277	33459	NAVAN ROAD (NW-EA)	D7	Yellow Box	at bus stop 1660 outbound.	30/08/2016	Stage 2	0
278	33466	MILLBOURNE AVENUE (NW-EA)	D9	Disabled Parking Bay (General)	Request to relocate a general disabled parking bay from outside the library to outside the health centre.	30/08/2016	Stage 2	0
279	33648	KINVARA PARK (NW-EA)	D7	Pay & Display Parking	at the parking area at the shops, Nos. 37-43.	06/09/2016	Stage 2	0
280	33681	MAREWOOD CRESCENT (NW-EA)		Speed Cushions	Need higher ramps to slow down cars.	09/09/2016	Stage 2	0
281	33699	GATEWAY MEWS (NW-EA)	D17	Double Yellow Lines	at entrance to the road.	20/09/2016	Stage 2	0

Item	Ref	Road	Post-code	Topic	Request Description	Date Rec'd	SR Status	No. Secondary Requests
282	33719	GLASANAON ROAD (NW-EA)	D11	School Warden Crossing Box	at the main entrance to Gael Scoil Ui Earcain.	12/09/2016	Stage 2	0
283	33733	MILLMOUNT AVENUE (NW-EA)	D9	Pedestrian Crossing	Request for above at Millmount House on the Fagan's side of the road!	09/09/2016	Stage 2	0
284	33735	GRIFFITH AVENUE (NW-EA)	D9	Pedestrian Crossing	Request for another pedestrian crossing south of the junction of Griffith Avenue and Drumcondra Road Upper.	13/09/2016	Stage 2	0
285	33783	VIOLET HILL DRIVE (NW-EA)	D11	Double Yellow Lines	request for DYs	14/09/2016	Stage 4	1
286	33819	SHANTALLA ROAD (NW-EA)	D9	Pedestrian Crossing	request for pedestrian crossings on the Shantall Road Bridge at the top of the bridge and at the bollards on the Shantalla Road end.	20/09/2016	Stage 2	0
287	33853	CARTON ROAD (NW-EA)		Speed Ramps	on above road 1-16	20/09/2016	Stage 4	0
288	33854	BALLYGALL CRESCENT (NW-EA)	D11	Speed Ramps	on above road	20/09/2016	Stage 2	0
289	33881	NAVAN ROAD (NW-EA)	D7	Traffic Calming	and Flashing Speed Signs (from Cabra Cross to Ashtown).	15/09/2016	Stage 2	0
290	33992	NORTH ROAD (NW-EA)	D11	Double Yellow Lines	outside gate of Brookfield Court Senior Citizens	21/09/2016	Stage 2	0
291	34107	BALLYMUN ROAD (NW-EA)	D11	Road Markings	road markings	28/09/2016	Stage 4	2

Item	Ref	Road	Post-code	Topic	Request Description	Date Rec'd	SR Status	No. Secondary Requests
292	34155	NAVAN ROAD (NW-EA)	D7	Traffic Calming	Traffic calming measures for Navan Rd, particularly at entrance to Darling Estate.	04/10/2016	Stage 2	0
293	34207	WHITEACRE CRESCENT (NW-EA)	D11	Traffic Calming	on the road.	18/10/2016	Stage 4	0
294	34444	SHANOWEN ROAD (NW-EA)	D9	Pedestrian Crossing	Opposite the Garda station	10/10/2016	Stage 2	0
295	34579	SHANOWEN ROAD (NW-EA)	D9	Pedestrian Crossing	at Cocoon Crèche, Block F, Milners Square.	17/10/2016	Stage 2	0
296	34582	HAMPSTEAD AVENUE (NW-EA)	D9	Double Yellow Lines	on the road.	17/10/2016	Stage 2	0
297	34645	CLARE ROAD (NW-EA)	D9	One-Way System	Request for above roads to be made one-way	19/10/2016	Stage 2	0
298	34650	FERNDALE AVENUE (NW-EA)	D11	One-Way System	in front of Mother of Divine Grace Primary School.	24/10/2016	Stage 4	1
299	34652	SHANOWEN CRESCENT (NW-EA)	D9	Single Yellow Line	on one side of the section of Shanowen Crescent coming in from Shanowen Road	20/10/2016	Stage 2	0
300	34654	OAKPARK AVENUE (NW-EA)	D9	Double Yellow Lines	from the entrance to Oak Park estate at Coolock Lane to the entrance to the Chapel of Blessed Margaret Ball, along east side of the avenue.	20/10/2016	Stage 5	1
301	34787	MELLOWES PARK (NW-EA)	D11	Parking Prohibition	Problem with people parking across house driveways .	28/10/2016	Stage 4	0
302	34794	CABRA ROAD (NW-EA)	D7	Pay & Display & Permit Parking	Parking scheme for Cabra Rd.	02/11/2016	Stage 2	0

Item	Ref	Road	Post-code	Topic	Request Description	Date Rec'd	SR Status	No. Secondary Requests
303	34817	BOTANIC VILLAS (NW-EA)	D9	Pay & Display & Permit Parking (change of hours)	for extension of hours until midnight and to include Sundays.	02/11/2016	Stage 3	0
304	34829	RATOATH ROAD (NW-EA)	D7	Speed Ramps	on Ratoath Road between Westwood and Dunsink Lane.	15/11/2016	Stage 2	0
305	34855	SAINT MOBHI BOITHIRIN (NW-EA)	D9	Double Yellow Lines (Rescind)	Remove DYLS in front of 1 Mobhi Mews.	07/11/2016	Stage 4	2
306	34888	SAINT DAVID'S TERRACE (NW-EA)	D9	Double Yellow Lines	laneway located off St. David's Terrace, Glasnevin	08/11/2016	Stage 4	0
307	34969	ABBOTSTOWN AVENUE (NW-EA)	D11	Speed Ramps	between 39 and 63 Abbotstown Avenue.	15/11/2016	Stage 2	0
308	34971	DRUMCLIFFE ROAD (NW-EA)	D7	Traffic Calming	on the road.	15/11/2016	Stage 2	0
309	34972	HOLLYBANK ROAD (NW-EA)	D9	Electric Car Bay	at the charger.	15/11/2016	Stage 2	0
310	35013	CRAWFORD AVENUE (NW-EA)	D9	Disabled Parking Bay (Residential)	outside No. 14. Pay and Display and Permit Parking will have to be rescinded.	11/11/2016	Stage 2	0
311	35047	CLARE ROAD (NW-EA)	D9	Stop Sign	Stop signs on above roads. Also Lambay and Rathlin Roads.	01/11/2016	Stage 2	0
312	35067	BANTRY ROAD (NW-EA)	D9	Disabled Parking Bay (Residential)	outside No. 35.	15/11/2016	Stage 2	0
313	35084	BLACKHORSE AVENUE (NW-EA)	D7	Pay & Display & Permit Parking	at Nos. 1 to 21, St. David's Terrace.	15/11/2016	Stage 2	0

Item	Ref	Road	Post-code	Topic	Request Description	Date Rec'd	SR Status	No. Secondary Requests
314	35305	CARTON TERRACE (NW-EA)	D11	Traffic Calming	Woman phoned complaining about speeding traffic on above road. Wants traffic calming measures put in place i.e. signs etc	30/11/2016	Stage 2	0
315	35329	SHANOWEN AVENUE (NW-EA)	D9	Yellow Box (Extend)	Extend DYL past ramp to the vehicular entrance gate of 688 Collins avenue ext	28/11/2016	Stage 2	0
316	35375	KILKIERAN ROAD (NW-EA)	D7	Speed Ramps (Rescind)	change position of speed ramps at Sancta Maria Day Centre.	20/12/2016	Stage 2	0
317	35379	BALLYMUN ROAD (NW-EA)	D9	Pay & Display & Permit Parking	on the section of road between Griffith Avenue and Old Finglas Road.	06/12/2016	Stage 4	0
318	35420	HILLCREST PARK (NW-EA)	D11	One-Way System	on Hillcrest Park.	06/12/2016	Stage 2	0
319	35514	OLD FINGLAS ROAD (NW-EA)	D11	Yellow Box	outside the entrance to St. Mary's Secondary School.	06/12/2016	Stage 2	0
320	35594	MAREWOOD CRESCENT (NW-EA)	D11	Pedestrian Crossing	on the road.	20/12/2016	Stage 2	0
321	35595	DRUMCLIFFE ROAD (NW-EA)	D7	Traffic Calming	to prevent rat-running from Ratoath Road.	20/12/2016	Stage 2	0
322	35598	TOLKA VALLEY ROAD (NW-EA)	D11	Speed Ramps	at the entrance from Ratoath Road.	20/12/2016	Stage 2	0
323	35631	GRIFFITH AVENUE (NW-EA)	D11	School Keep Clear	outside the Educate Together National School, Griffith Avenue Extension.	20/12/2016	Stage 2	0

Item	Ref	Road	Post-code	Topic	Request Description	Date Rec'd	SR Status	No. Secondary Requests
324	35632	GRIFFITH AVENUE (NW-EA)	D11	Pedestrian Crossing	outside the Educate Together National School, Griffith Avenue Extension.	20/12/2016	Stage 5	0
325	35780	BALLYMUN ROAD (NW-EA)	D9	School Warden	at Our Lady of Victories School.	09/01/2017	Stage 2	2
326	35781	WESTWOOD ROAD (NW-EA)	D11	Speed Ramps	on the road.	09/01/2017	Stage 4	0
327	36027	POPPINTREE PARADE (NW-EA)	D11	Disabled Parking Bay (General)	opposite Poppintree Pharmacy.	18/01/2017	Stage 2	0
328	36034	COLLINS AVENUE (NW-EA)	D9	Traffic Island	on Collins Ave West, west of junction with Swords Road	09/01/2017	Stage 2	0
329	36099	GRIFFITH ROAD (NW-EA)	D11	3 Tonne Limit	on the road.	19/01/2017	Stage 2	0
330	36128	BALLYGALL ROAD EAST (NW-EA)	D11	Filter Light	Right turn filter lights from Ballygall Road East onto Griffith Avenue and Griffith Avenue onto Ballygall Road East.	10/01/2017	Stage 4	0
331	36136	BOTANIC VILLAS (NW-EA)	D9	Parking Prohibition	for entrance to Botanic Villas, adjacent to 120 Botanic Road.	11/01/2017	Stage 4	0
332	36160	GRIFFITH AVENUE (NW-EA)	D9	Yellow Box	outside No. 265, see 36161	16/01/2017	Stage 4	0
333	36161	GRIFFITH AVENUE (NW-EA)	D9	Double Yellow Lines (Extend)	request to extend existing DYs 3m west (outside No. 256) See also SR 36160	16/01/2017	Stage 2	0

Item	Ref	Road	Post-code	Topic	Request Description	Date Rec'd	SR Status	No. Secondary Requests
334	36168	BENEAVIN ROAD (NW-EA)	D11	Double Yellow Lines	from Beneavin College to Beneavin Nursing Home, on both sides of the road.	17/01/2017	Stage 2	0
335	36258	WELLMOUNT AVENUE (NW-EA)	D11	Children Crossing Sign	outside Brigid's School	18/01/2017	Stage 2	0
336	36316	GRIFFITH AVENUE (NW-EA)	D9	Clearway	eastbound between bus stop No. 188 & Swords Road.	02/02/2017	Stage 2	0
337	36375	CREMORE HEIGHTS (NW-EA)	D11	Speed Ramps	request for speed ramps	24/01/2017	Stage 2	0
338	36378	JOHNSTOWN PARK (NW-EA)	D11	Double Yellow Lines	request for DYLS at junction	24/01/2017	Stage 2	0
339	36380	GLENDUN ROAD (NW-EA)	D9	Children Crossing Sign	request for signs near green	24/01/2017	Stage 2	0
340	36394	GALLAUN ROAD (NW-EA)	D11		To investigate an issue with parking on Gallaun Road.	06/02/2017	Stage 2	0
341	36395	DANE ROAD (NW-EA)	D11	Speed Ramps	on the road.	06/02/2017	Stage 2	0
342	36415	CLONMEL ROAD (NW-EA)	D9	Parking Prohibition	around laneway area - shortcut to school	24/01/2017	Stage 2	0
343	36473	SWORDS ROAD (NW-EA)	D9	Right Turn Filter Light	from Swords Road onto Santry Villas.	27/01/2017	Stage 4	0
344	36474	SHANLISS ROAD (NW-EA)	D9	Double Yellow Lines	at house No.9	27/01/2017	Stage 2	0
345	36487	THE THATCH ROAD (NW-EA)	D9	Traffic Lights	at the junction of The Thatch Road and Beaumont Road.	27/01/2017	Stage 2	0
346	36503	FARNHAM DRIVE (NW-EA)	D11	3 Tonne Limit	on Farnham Drive from the junction with Wellmount Road to the gates of Erin's isle.	21/02/2017	Stage 4	0

Item	Ref	Road	Post-code	Topic	Request Description	Date Rec'd	SR Status	No. Secondary Requests
347	36626	DALCASSIAN DOWNS (NW-EA)	D11	Double Yellow Lines	on either side of the entrance to No. 2.	08/02/2017	Stage 2	0
348	36692	COLLINS AVENUE EXTENSION (NW-EA)	D9	Yellow Box	markings at the junction.	02/02/2017	Stage 4	0
349	36699	FINGLAS ROAD (NW-EA)	D11	Pedestrian Crossing	at the slip road on the Finglas Road at junction with Ballyboggan Road.	03/02/2017	Stage 2	0
350	36731	SAINT MOBHI ROAD (NW-EA)	D9	Yellow Box	at the junction of St. Mobhi Boithirin, outbound lane.	06/02/2017	Stage 2	0
351	36738	SHANDON CRESCENT (NW-EA)	D7	Pay & Display & Permit Parking	on the road.	23/01/2017	Stage 2	0
352	36748	HILLCREST PARK (NW-EA)	D9	Double Yellow Lines	request for double yellow lines	09/02/2017	Stage 2	0
353	36766	BOTANIC AVENUE (NW-EA)	D9	No Right Turn	from Botanic Ave onto Mobhi Road, to alleviate traffic on former	07/02/2017	Stage 2	0
354	36769	RATOATH ROAD (NW-EA)	D7	Yellow Box	yellow box on a roundabout	09/02/2017	Stage 2	0
355	36773	DEAN SWIFT ROAD (NW-EA)	D9	Double Yellow Lines	DYs corner of Dean Swift Road/ St Pappins Rd.	10/02/2017	Stage 2	0
356	36811	SAINT HELENA'S DRIVE (NW-EA)	D11	Double Yellow Lines	entrance to Merville Court senior citizens complex.	01/03/2017	Stage 2	0
357	36817	CABRA ROAD (NW-EA)	D7	Yellow Box	at entrance to Rose Court Apartment Complex Cabra Rd.	01/03/2017	Stage 2	2

Item	Ref	Road	Post-code	Topic	Request Description	Date Rec'd	SR Status	No. Secondary Requests
358	36831	POPPINTREE PARADE (NW-EA)	D11	Pay & Display & Permit Parking	Introduction of pay and display at the neighbourhood centre, Poppintree Parade, off Belclare View.	21/02/2017	Stage 2	0
359	36862	SYCAMORE ROAD (NW-EA)	D11	Pedestrian Crossing	at junction of Sycamore Rd / McKee Road	08/03/2017	Stage 2	0
360	36898	CRANOQUE TERRACE (NW-EA)	D11		Yield /Stop sign at either end of Cranogue Terrace at junction of Cranogue Road and Balbutcher Way.	17/02/2017	Stage 2	0
361	36903	CRESTFIELD PARK (NW-EA)	D9	Single Yellow Line	along the green.	06/03/2017	Stage 4	2
362	36907	BERRYFIELD ROAD (NW-EA)	D11	Speed Ramps	at the junction of Berryfield Road and Berryfield Drive.	06/03/2017	Stage 2	0
363	36934	POPPINTREE PARK LANE WEST (NW-EA)	D11	Pedestrian Barrier	between Parkview and Holywell.	21/03/2017	Stage 2	0
364	36937	BALLYMUN ROAD (NW-EA)	D11	Yellow Box	at the Axis Centre.	21/03/2017	Stage 2	0
365	36945	COOLEEN AVENUE (NW-EA)	D9	Traffic Calming	on the road.	21/03/2017	Stage 2	0
366	36947	COOLRUA DRIVE (NW-EA)	D9	Traffic Calming	on the road.	21/03/2017	Stage 2	0
367	36951	CLANCY ROAD (NW-EA)	D11	Traffic Calming	including speed ramps and a road closure.	21/03/2017	Stage 2	0
368	36994	GRIFFITH AVENUE (NW-EA)	D9	Bus Lane	on approach to St Mobhi Road.	13/03/2017	Stage 4	0

Item	Ref	Road	Post-code	Topic	Request Description	Date Rec'd	SR Status	No. Secondary Requests
369	36995	JAMESTOWN ROAD (NW-EA)	D11	Traffic Calming	request for additional traffic calming on the road.	13/03/2017	Stage 2	0
370	37000	COLLINS AVENUE EXTENSION (NW-EA)	D9	Traffic Lights	at the junction of Crestfield Drive at St Aidan's CBS.	06/03/2017	Stage 2	0
371	37093	WELLMOUNT ROAD (NW-EA)	D11	Children Crossing Sign	opposite 'The Cabin' Shop, No. 47b.	20/03/2017	Stage 2	0
372	37107	GLENBEIGH ROAD (NW-EA)	D7	Pedestrian Crossing	Some form of traffic calming, preferably pedestrian crossing, at junction of Glenbeigh Road and Old Cabra Road.	28/02/2017	Stage 2	0
373	37172	MC KELVEY AVENUE (NW-EA)	D11	Pedestrian Crossing	at McKelvey Avenue / St. Margaret's Road.	09/03/2017	Stage 2	0
374	37271	KILKIERAN ROAD (NW-EA)	D7	Stop Sign	On Kilkieran Road at the junction of Bannow Road.	22/03/2017	Stage 2	0
375	37285	BALLYMUN ROAD (NW-EA)	D11	Disabled Parking Bay (General)	Two bays outside Ballymun Library.	23/03/2017	Stage 2	0
376	37318	CABRA ROAD (NW-EA)	D7	Yellow Box	Yellow box on Cabra Road at junction with Charleville Road.	15/03/2017	Stage 2	0
377	37326	MCKEE AVENUE (NW-EA)	D11	Bus Cage Marking	request for bus cage extension.	31/03/2017	Stage 4	0
378	37331	KILKIERAN ROAD (NW-EA)	D7	Speed Ramps	at the junction of Kilkieran Road and Bannow Road.	22/03/2017	Stage 2	0

Item	Ref	Road	Post-code	Topic	Request Description	Date Rec'd	SR Status	No. Secondary Requests
379	37353	CHURCH AVENUE (NW-EA)	D9	Pay & Display & Permit Parking (extension of area)	request for two additional bays instead of DYs from No. 22 to entrance to All Hollows Lane.	21/02/2017	Stage 2	0
380	37356	BALLYMUN ROAD (NW-EA)	D11	Disabled Parking Bay (General)	Request for additional bays outside the Ballymun Civic Centre.	31/03/2017	Stage 2	0
381	37512	CARTON TERRACE (NW-EA)	D11	Traffic Lights	with Pedestrian Phase at the junction of Carton Terrace and Balbutcher Lane.	05/04/2017	Stage 1	0
382	37526	ARRAN ROAD (NW-EA)	D6	Disabled Parking Bay (Residential)	Appeal in relation to the proposed installation of a disabled parking bay outside No. 28	11/04/2017	Stage 1	4
383	37554	SWORDS ROAD (NW-EA)	D9	Traffic Lights	at the Swords Road slip road coming out of the Omni Park Shopping Centre.	04/04/2017	Stage 1	0
384	37576	GLENTIES PARK (NW-EA)	D11	Parking Prohibition	at the junction of Glenties Park and Cardiffsbridge Road.	04/04/2017	Stage 1	0
385	6328	RIVER ROAD (NW-EA)	D15	Speed Ramps	additional Ramp around the corner from Pelletstown Manor.	25/02/2013	Stage 3	7
386	6358	SHANGAN ROAD (NW-EA)	D11	Traffic Lights	At junction of Balbutcher Lane and Balcurriss Road	04/03/2013	Stage 2	3
387	6375	BALBUTCHER LANE (NW-EA)	D11	Traffic Lights	at junction of Sillogue Road.	28/02/2013	Stage 5	0

Item	Ref	Road	Post-code	Topic	Request Description	Date Rec'd	SR Status	No. Secondary Requests
388	6706	BALCURRIS ROAD (NW-EA)	D11	Pedestrian Refuge Island	At pedestrian lights at rear of Ballymun Shopping Centre facing Plunkett Tower.	27/03/2013	Stage 5	0
389	7855	CARRIG ROAD (NW-EA)	D13	Speed Ramps	between Knowth & Druid Court.	26/06/2013	Stage 5	1
390	8263	IONA ROAD (NW-EA)	D9	Traffic Island	Request for traffic island or build out at the junction of Crawford Avenue.	08/08/2013	Stage 5	1
391	8385	CRANOQUE ROAD (NW-EA)	D11	Speed Ramps	Appeal to S.R 6320 - Reps for Ramps on Cranogue Road	19/08/2013	Stage 2	1
392	8665	OLD CABRA ROAD (NW-EA)	D7	Traffic Calming	Request for traffic calming measures at the junction of North Circular Road/Old Cabra Road/Prussia Street, at Hanlon's Corner.	12/09/2013	Stage 2	0
393	8673	SAINT PATRICK'S ROAD (NW-EA)	D9	No Left Turn	Request for no left turn from St. Patrick's Road onto Whitworth Road, during morning peak.	12/09/2013	Stage 4	1
394	8810	COULTRY DRIVE (NW-EA)	D9	Speed Ramps	close to No. 27.	07/10/2013	Stage 5	2
395	9683	BALBUTCHER LANE (NW-EA)	D11	Traffic Calming	at its junction with Carton Terrace/Carton Drive.	02/12/2013	Stage 5	0
396	9921	CRAWFORD AVENUE (NW-EA)	D9	Buildout	near the junction of Iona Road.	06/12/2013	Stage 5	0

**The Chairman and Members of
North West Area Committee.**

Meeting: 16th May 2017

Item No: 16

North West May Area Agenda 16/05/17 (TAG Date: 25/04/17)											
Item	Request	Ref	Road	Post-code	Topic	Request Description	Request by	TAG Result	TAG Comments	Sec	Date Rec'd
1	Parking Prohibitions	35379	BALLYMUN ROAD (NW-EA)	D9	Pay & Display & Permit Parking	on the section of road between Griffith Avenue and Old Finglas Road.	resident	Not Recommended	From a site visit it was deemed that Pay & display & Permit Parking was not advisable due to a significant bend on the road limiting sight lines for vehicular traffic. In addition to this, vehicles will encroach on to the opposite side of the road in order to pass parked cars.	0	06/12/2016
2		33853	CARTON ROAD (NW-EA)		Speed Ramps	on above road 1-16	resident	Not Recommended	Carton Road does not meet the criteria for Speed Ramps. For traffic calming the following criteria applies: • The road should have a straight run of at least 200m. • Traffic volumes should exceed 60 vehicles per hour. There is on street parking which narrows the carriageway and effectively acts as traffic calming and reduces forward visibility. During a site visit no adverse problems relating to speeding were observed.	0	20/09/2016

3	Traffic Conditions	8385	CRANOGUE ROAD (NW-EA)	D11	Speed Ramps	on the road.	resident	Not Recommended	Cranogue Road does not meet the warrant for the introduction of traffic calming measures, the road should have a straight run of at least 200m. Isolated instances of speeding are a matter of enforcement under the law by the Gardaí.	1	19/08/2013
4	Traffic Signs	30870	CRANOGUE ROAD (NW-EA)	D11	Yield Sign	at the junction of Cranogue Terrace.	resident	Recommended	Install Yield Signs RUS 026 and associated road markings, on Cranogue Terrace at the junction with Cranogue Road.	0	19/04/2016
5	Traffic Conditions	36375	CREMORE HEIGHTS (NW-EA)	D11	Speed Ramps	request for speed ramps	deputy Rock	Not Recommended	The criteria used to determine the need for traffic calming measures are as follows: • The road should have a straight run of approximately 200 metres. • The 85th percentile speed (speed exceeded by 15% of vehicles) should exceed 50km/h. • Traffic volumes should exceed 60 vehicles per hour. • There should be genuine road safety concerns based on accident statistics or observed road safety patterns Cremore Heights does not meet the criteria for traffic calming as it has only a straight run of 90m.	0	24/01/2017
6	Traffic Conditions	20494	DANE ROAD (NW-EA)	D11	Speed Ramps	Request for speed ramps on St Josephs Way, off Dane Road, beside Cairn Court	resident	Not Recommended	St. Joseph's Way does not meet the warrant for the introduction of traffic calming measures, the road should have a straight run of at least 200m and must exceed 60 vehicles per hour. Isolated instances of speeding are a matter of enforcement under the law by the Gardaí.	0	30/09/2015
7	Traffic Signs	20704	DELVILLE ROAD (NW-EA)	D11	Stop Sign	at the junction of Delville Road and St Pappin's Road.	cllr Connaghan	Recommended	Rescind existing Yield Sign and markings and Install Stop Sign RUS 027 on Delville Road at the junction with St. Pappin Road. Install accompanying Stop Line RRM 017, including the worded STOP Marking M114.	0	20/10/2015

8	Traffic Conditions	18409	FINGLAS PLACE (NW-EA)	D11	Traffic Calming	on the road.	resident	Not Recommended	SR Not Recommended. It is not recommended to install traffic calming measures on Finglas Place as it does not meet the criteria, It must be a road that is a straight run of 200m to be considered.	1	28/05/2015
9	Traffic Conditions	20189	GLENTIES DRIVE (NW-EA)	D11	Speed Ramps	on the road.	cllr Connaghan	Not Recommended	The road is currently traffic calmed with the provision of ramps, and installation of more ramps will only encourage harsh braking and consequent heavy acceleration in between. Children Crossing' signs should not be recommended for main roads, traffic calmed roads or cul de sacs. In an urban environment with the large number of informational, directional and warning signs it is important to manage the number of signs erected to help maintain their effectiveness. The excessive allocation (or proliferation) of such warning signs also undermines their effectiveness at better warranted locations. It is not recommended to install Children Crossing signs on Glenties Drive. The Road in question is a Cul de Sac and has on street parking within a residential area where the onus is on the motorist to behave in a manner suitable to the obvious prevailing conditions.	0	15/09/2015
10	Traffic Signs	14750	IONA CRESCENT (NW-EA)	D9	Stop Sign	'Stop' <u>or</u> 'Yield' Sign at the junction of Iona Villas.	dcc area office	Not Recommended	From Site inspection it was observed that there currently is a yield sign located on Iona Villas with the junction of Iona Crescent.	0	13/10/2014

11	Parking Prohibitions	32668	KEMPTON AVENUE (NW-EA)	D7	Double Yellow Lines	in the estate	deputy Chambers	Not Recommended	It is not recommended to install Double Yellow Lines on the right hand side of at the entrance to Kempton Avenue as installing them will only lead to parking further within the estate. The parking of cars at the current location also offers traffic calming by way of narrowing the carriageway and reduces forward visibility. Double Yellow Lines are currently in place around the corner of Kempton Avenue turning left, these lines do not need to be extended as no cars were observed to be parking along the corner. It is also illegal to park opposite the continuous white line (Under The Road Traffic (Traffic & Parking) Regulations, Section 36 paragraph(2) (d) "A vehicle shall not be parked on a section of roadway with less than 3 traffic lanes and where traffic sign number RRM 001 [continuous white line] has been provided.) Once the road straightens up there is no need for double yellow lines as sight lines are good and parked cars offer traffic calming. During a site visit no adverse problems relating to speeding were observed. Infringements should be reported to Dublin Street Parking Services tel no. 01 6022500 or the Gardaí as they occur.	1	12/07/2016
12	Parking Prohibitions	28375	LORCAN AVENUE (NW-EA)	D9	Double Yellow Lines	at the junction of Lorcan Avenue and Lorcan Park.	deputy Rock	Not Recommended	Double Yellow Lines are not recommended on the corners of Lorcan Avenue and Lorcan Park as parking prohibitions are already in place by law; Under The Roads Traffic Act (Traffic & Parking) Regulations, Section 36 (c) a vehicle shall not be parked on a public road within 5 metres of a road junction. Illegal parking should be reported to the Gardaí or Dublin Street Parking Services, for enforcement under the law.	1	15/12/2015

13	Traffic Signs	28376	LORCAN AVENUE (NW-EA)	D9	Yield Sign	at the junction of Lorcan Avenue and Lorcan Park.	deputy Rock	Not Recommended	Under the road traffic act , traffic on a road ending at a T junction must give way to traffic from either direction on the other road. Likewise, when exiting a private entrance you must yield to traffic on a public road. A stop/yield sign is not necessary where normal rules of the road apply, moreover such signs are only provided on approaches to major junctions, otherwise this would lead to a proliferation of signs throughout residential estates. Therefore this request is not recommended.	0	15/12/2015
14	Admin	37326	MCKEE AVENUE (NW-EA)	D11	Bus Cage Marking	request for bus cage extension.	dublin bus	Recommended	Extend the Bus Stop Marking and rescind DYL's. STAT Install Bus Stop Marking RRM 030 on the East Side McKee Avenue starting from a Point 3.5m South of Lamp Standard 5, extending north for 19.1m Rescind Double Yellow Lines on the East Side of McKee Avenue starting from a Point 10.4m South of Lamp Standard 5, heading south for 3.5m	0	31/03/2017
15	Traffic Signs	37424	NEPHIN ROAD (NW-EA)	D7	Right Turn Only	Request for right turn only lane at Junction of Nephin Road Navan Rd.	resident	Recommended	SR Recommended Rescind M 125 (Direction Arrow-Ahead & Right) road marking on Nephin Road at the Junction with Navan Road, and Install road marking RRM 006 (Direction Arrow-Right).	0	29/03/2017
16	Traffic Conditions	14059	PINEWOOD AVENUE (NW-EA)	D11	Speed Ramps	on the road	resident	Not Recommended	Following a recent speed survey over a 12 hour period, it was shown that the 85th Percentile speed was 48km/h and that speed violations were below 10% along Pinewood Avenue. Pinewood Avenue also has on street parking which effectively narrows the carriageway and reduces forward visibility, this acts as traffic calming. It is therefore not recommended to introduce ramps at this time.	2	15/09/2014

17	Traffic Conditions	19062	SAINT EITHNE ROAD (NW-EA)	D7	Speed Ramps	for ramps on road.	dcc area office	Not Recommended	Saint Eithne Road does not meet the warrant for the introduction of traffic calming measures, the road should have a straight run of at least 200m. From site inspection it was observed that cars were parked on the road, this offers traffic calming by physically narrowing the carriageway and reducing drivers forward visibility.	0	07/07/2015
18	Traffic Conditions	37638	SAINT HELENA'S DRIVE (NW-EA)	D11	Yellow Box		resident	Recommended	Recommend Installation of Double Yellow Lines on Saint Helena's Drive STAT: Install Double Yellow Lines on the south side of Saint Helena's Drive starting from a point 7m east of Lamp Standard 2 and extending westwards for 15m.	0	24/04/2017
19	Traffic Signs	31350	SHANTALLA ROAD (NW-EA)	D9	Stop Sign	at the roundabout at the junction of Shantalla Road and Swords Road.	cllr Reilly	Not Recommended	It is not recommended to place a Stop Sign at a roundabout, yield signs are placed at each approach to roundabouts, and vehicles must always yield to traffic coming from the right.	0	09/05/2016

20	Traffic Signals	36473	SWORDS ROAD (NW-EA)	D9	Right Turn Filter Light	from Swords Road onto Santry Villas.	deputy Rock	Not Recommended	Dublin City Council makes every effort to ensure that all road users are accommodated within the phasing and sequencing of traffic signals and management of traffic movements. The ITS section Dublin City Council has evaluated the junction at Swords Road / Santry Avenue and cannot, at this time, recommend the installation of a right turn filter from Swords Road to Santry Villas. This is a busy junction with lots of movements to be accommodated. In order to provide a right turn filter as requested signal timing would need to be removed from other approaches which would increase overall congestion and, most importantly, delay the many bus routes that operate via this junction. Traffic movements at this junction will continue to be monitored and, if necessary, consider what changes may be beneficial.	0	27/01/2017
21	Admin	15787	SYCAMORE PARK (NW-EA)	D11	Engineer Query	to arrange for a traffic inspection at the junction of Sycamore Park and Sycamore Road.	cllr Connaghan	Not Recommended	Double yellow lines are not recommended on the corners of the junction Sycamore Park/Sycamore Road as parking prohibitions are already in place by law; Under The Roads Traffic Act (Traffic & Parking) Regulations, Section 36 (c) ""a vehicle shall not be parked on a public road within 5 metres of a road junction. Illegal parking should be reported to the Gardai or Dublin Street Parking Services, for enforcement under the law. Section 36 (2) Road Traffic Act a vehicle shall not be parked - (i) on a foot way, a grass margin or a median strip. Infringements of the Act should be reported Dublin Street Parking Services Upon a site visit no cars were parked near the junction and visibility was not impeded for vehicles or pedestrians.	0	16/12/2014

22	Traffic Conditions	20685	VALLEY PARK ROAD (NW-EA)	D11	Speed Ramps	at entrance.	cllr Murphy	Not Recommended	Valley Park Road is already traffic calmed with the provision of five no. Speed Ramps. As per the traffic management guidelines it is poor design to have traffic calming features that are spaced too close as it encourages harsh braking and consequent heavy acceleration in between. It is therefore not recommended to install additional an additional speed ramp at the entrance of Valley Park Road.	0	20/10/2015
23	Parking Prohibitions	33783	VIOLET HILL DRIVE (NW-EA)	D11	Double Yellow Lines	request for DYLS	resident	Not Recommended	From numerous site visits at different times of the day, no parking issues were observed at the location. It is not recommended to install double yellow lines at this location, double yellow lines are intended to ensure the smooth flow of traffic and to prevent hazards and congestion. If double yellow lines were installed at the location it will not legally prevent persons from parking as they are by right, allowed to park for loading and unloading for 30 minutes.	1	14/09/2016
24	Traffic Conditions	35781	WESTWOOD ROAD (NW-EA)	D11	Speed Ramps	on the road.	cllr Murphy	Not Recommended	Westwood Road does not meet the criteria for Speed Ramps. For traffic calming the following criteria applies: • The road should have a straight run of at least 200m. • Traffic volumes should exceed 60 vehicles per hour. There is on street parking which narrows the carriageway and effectively acts as traffic calming and reduces forward visibility. During a site visit no adverse problems relating to speeding were observed.	0	09/01/2017
25	Traffic Conditions	34207	WHITEACRE CRESCENT (NW-EA)	D11	Traffic Calming	on the road.	cllr Reilly	Not Recommended	Whiteacre Crescent does not meet the warrant for the introduction of traffic calming measures, the road should have a straight run of at least 200m. Isolated instances of speeding are a matter of enforcement under the law by the Gardaí.	0	18/10/2016

26	Traffic Conditions	15609	WHITWORTH ROAD (NW-EA)	D9	Speed Ramps	to replace the Speed Cushions with Speed Ramps.	dcc area office	Not Recommended	As this road forms part of a bus route, speed cushions rather than ramps were provided to facilitate emergency vehicles and safety of bus passengers.	1	26/11/2014
27	Traffic Signs	27740	YELLOW ROAD (NW-EA)	D9	Stop Sign	on Yellow Road at the junction with The Thatch Road.	cllr Carney Boud	Not Recommended	Under the Road traffic Act, traffic on a road ending at a T junction must give way to traffic from either direction on the other road. A stop sign is not necessary where normal rules of the road apply, moreover such signs are only provided on approaches to major junctions, otherwise this would lead to a proliferation of signs throughout residential estates. It is noted that these roads are Residential in nature, Yellow Road and Thatch Road are also traffic calmed.	0	17/11/2015

**The Chairman and Members of
North West Area Committee.**

Meeting: 16th May 2017

Item No: 18

Ballymun Area Office Report

- 1. Community Update**
- 2. Housing/Estate Management**
- 3. Ballymun Economic Development/Town Civic Alliance**
- 4. Safer Ballymun/Drumcondra Glasnevin**

1. Community Update

General Community

Team members attended the following meetings: Santry Community Centre Board Meeting, Poppintree Neighbours Day Meeting(s), Ballymun Allsorts, DNWAP, Ballymun Men's Shed, Oak Park Residents, BADIG, Otherworld Festival Meetings, LIFT Festival, Santry Community Centre (10th Anniversary Events), and Poppintree Health for All Group. A summer project network meeting took place with the five voluntary projects on Thursday the 27th April and ongoing assistance and meetings will take place with the volunteers, Crosscare Representative, Roisin Cloake and community team members.

Social Inclusion

Men's Sheds

Community team members have had a number of meetings with the Ballymun Men's Shed to help facilitate the group's progress. Meetings in relation to possible premises in DCU and Shanliss Road are ongoing. Team members attended meetings with the Irish Men's Sheds Association with their new volunteer shed co-ordinators coming on stream in the near future. A Men's Health Event took place in Trinity Sports and Father Collins Park, Donaghmede on the 11th April.

Older Persons

Community team members linked with the following groups: U3A, Active Living, Coultury Crafts, Age Friendly Group, Whitehall Active Retirement Group, and BADIG.

Ladies Groups

Community team members provide ongoing support to Sillogue Ladies Group and ongoing assistance to the Sillogue Neighbourhood Centre as they grow their user groups, in particular assisting with the Easter Bonnet Event which took place on 12th April and the FACT (Families with Autism Coming Together) Mad Hatters Party which took place on April 27th for Autism Awareness Month. Ballymun Area Office recently funded a new good quality floor for the main room and good quality chairs for events.

Mental Health

Team members are continuing to meet in relation to the Green Ribbon campaign, and will promote this campaign at the Ballymun in Bloom Event and Breakfast Bingo Event in Sillogue Neighbourhood Centre. Ribbons will be distributed to various community groups. Team members attended a number of meetings in relation to the MOJO Project (housed in BRYR).

Environmental

The team worked with Public Domain staff to run the Big Clean Up event on Good Friday. Over twenty local groups signed up to this event. Team members are also linking with Public Domain and Waste Management staff in relation to this years' PRIDE of Place Entry for the North West Area (the residents and environmental upgrades in Doon Court, Graigue Court and Knowth Court). The team are putting the final plans together for plant deliveries in mid May and at the start of June. Further meetings have taken place with GAP Ballymun in relation to five greening area workshops for the year. Team members have been working with STAR Ballymun to help them refurbish their community garden space in the Horizon Building. Team members have been liaising with local environmental groups around their City Neighbourhood Application Forms.

Events

Community team members are working with Poppintree Community Centre, Poppintree Youth Project, Aisling Poppintree, Garda Diversion Project and St Margaret's Development Centre to hold a Family Day Event on Thursday June the 29th from 2-5pm. This day will have "overcoming diversity" as a background theme and will focus on the idea of getting to know your neighbour better. Sports activities, music and food will be provided at this event.

2. Housing/Estate Management Updates

C.C.T.V

The initial work on integrating the two operating systems has been completed. The remaining work on the system will continue on a phased basis throughout the year.

Cleansing / Waste Management

Waste Management and the Area Office are continuing to combat illegal dumping at open spaces. These measures include using the C.C.T.V system to monitor and identify those responsible. The area office has targeted illegal dumping around, Coultury, Belclare and Termon Court. Tenants have been called for interview and warned about their behaviour.

Insulation Programme

The work on the units in Coultury and Shangan has been completed. The insulation works are now on going in Sillogue Gardens.



Dumping

Public Domain in conjunction with the Project Estate Officers in Ballymun continues to target residents who are illegally dumping. There is currently a dumping programme in place to try and target households who have no bin providers. Any householders suspected of having no provider are written to and asked to send in evidence of their bin collection receipts. This will be followed up by a further two letters, at this point if receipts are not received they will be called in for interview in the Housing Office.

Big Dublin Clean-Up

Public Domain organised a massive cleanup in Ballymun/Whitehall and Santry on Good Friday and more than 20 groups took part in this event. It was a huge success and as a result, some new groups are coming together to start up environmental groups in their areas and improve their roads/streets/green spaces. DCC Community staff was also on board to assist and support. Shangan Avenue made a huge effort with the amazing support of one local representative, who came down with a crew of men and helped dig out flower beds around the trees and take out huge roots, a wonderful effort by his crew and all the residents. A planting project will now take place in each tree bed. Residents in Knowth and Druid Court made a huge effort in tidying up the green spaces at each parking bay and dug the edgings all along the length of the road. It makes a huge difference and looks so much tidier. Public Domain will be working with these groups along with Community Section to do large flower beds and edging beds in the coming weeks. It was great to see local representatives Deputy Dessie Ellis TD and Councillor Noeleen Reilly present on the day engaging with residents and giving a hand with the clean ups.



Senior Citizens

There are a number of new environmental projects that Public Domain and Housing in Ballymun has identified. A major project has been undertaken in the Albert College complex and this work will include removing overgrown bushes, shrubs and weeds in the three garden areas with a view to having them paved and some planters installed. We are hoping that some small planters due to be fitted will be easier for residents to manage and enjoy. The Public Domain team are working with the Liaison Officer in Sandyhill Gardens Senior Citizens complex and have started a planting project along with residents. There are plans to put in high planters that the residents can easily reach and plants, equipment and topsoil etc. will be provided. Two benches and a large planter are being installed in Griffith Crescent so that residents can enjoy the lovely green space there. DCC has provided shovels, a

hose, long handled shears and plants in order to assist the older people looking after the green space.

Graffiti

Contractors are currently working on the list from the Graffiti removal programme run by Public Domain.

Residents Groups

The Public Domain office is constantly linking in with groups and is always working to get new groups on board. DCC continues to provide all clean up equipment and garden equipment needed for groups to do clean up and planting projects. New groups are continuing to come on board and all the hard work by residents and DCC is having a positive effect in the area, with the result that more areas are looking to form environmental groups. DCC has made contact with new groups in Balcurris Park East, Hollytree Square and Forestwood Avenue with a view to organising a cleanup and then maybe some planting projects with Community Section.

CRM

The system for logging complaints is updated daily and all jobs delegated to appropriate supervisors. You can log any complaints of a public domain nature on Fixmystreet.ie

Carton

Public Domain in conjunction with Tiglin is trying to engage with the residents of Carton Estate as there is a serious problem with dumping in this area. DCC undertook a cleanup of the green space facing Carton Drive last Saturday and filled 6 skip bags and 30 bags of rubbish which was removed by DCC staff. Young and old residents got involved and we also had residents from the Travellers site helping which was fantastic. Sharon from GAP as well as DCC Community staff was present lending a hand as always. We will continue to work with residents to improve this area and try to establish a better sense of community. Work was done by residents to the green space facing Carton Terrace and the edgings were all tidied and 2 flower beds put in which enhances the look of the area.

Clean-ups

Skip bags have been organised for some of our tenants in the Coultrey area and also for tenants in the Collins Place/ Collins Drive in the Finglas East area.

Ballymun Rent Assessment Update	
	April 2017
Assessments	268
Permission To Resides	6
Refunds	14
Opening of Accounts	12
Closing of Accounts	2
Front Counter Calls	327
Window Replacements	5

Ballymun Lettings April- 2017

Allocation Category	Housing List	Transfer List
Band 1 Priority		
Welfare	1	
Travellers	1	
Surrendering Larger		1
Medical	2	
Homeless	7	
Regen		
Band 2	6	1
Band 3	4	6
Sub Total	21	8
Total Lettings	29	

Estate Management January - April 2017

No of Anti social complaints per 1997 act Drug Related	18
No of Anti social complaints per 1997 act Not Drug Related	62
No of other Complaints	
Total Complaints	80
No of Anti Social Interviews per 1997 act	14
No of Other Interviews	14
Total Interviews	28
No Requests for mediation	
No of Complaints referred to central unit for Action	
No of Section 20 Evictions	
No of excluding Orders applied for by Tenant	
No of Excluding orders applied for by DCC	
No of surrender of Tenancies due to Anti Social Behaviour	
No of Tenancy Warnings sent to Central Unit	
No of Court Orders Granted	
No of Appeals / Judicial Reviews Challenges	
No of Warrants executed (Evictions)	

Ballymun Voids

Address	Number	Type	
Ballygall Crescent	36	3 Bed	Under Repair
Ballygall Parade	79	2 Bed	Under Repair
Ballygall Parade	87	2 Bed	Under Repair
Carton Road	1	3 Bed	Under Repair
Collins Place	11	2 Bed	Under Repair
Whiteacre Place	36	1 Bed	Under Repair
Carton Way	12	1 Bed	Under Repair
Longdale Terrace	36	2 Bed Apt	Under Repair
Marewood Drive	32	1 Bed	Under Repair
Shangan Crescent	19	2 Bed	Under Repair
Woodhazel Terrace	43	1 Bed	Under Repair
Sandyhill Terrace	30	1 Bed	Under Repair
Sandyhill Terrace	25	2 Bed	Under Repair
Forestwood Ave	69	3 Bed	Under Repair
Druid Court	45	3 Bed	Under Repair
Belclare Ave	10	3 Bed	Under Repair
Woodhazel Close	12	1 Bed	Under Repair
Collins Place	21	2 Bed	Under Repair
Owensilla	7	2 Bed	Under Repair
Carton Way	4	1 Bed	Under Repair
Carton Road	10		Under Repair
Senior Citizens			
Ard Na Meala	40	OPU	Under Repair
Albert College	17,25	OPU	Under Repair
Hampstead Court	36,	OPU	Under Repair
Burren Court	36,41	OPU	Under Repair
Botanic Avenue	139, 147,105,133	OPU	Under Repair
Sandyhill Gdns	20f	OPU	Under Repair
Pyrite Refurb			
Sandyhill Terrace	5		
Doon Court	8		
Owensilla	53		
Carton Close	4		
Pyrite Long Term			
Carton Court	12		
Carton Court	1		
Carton Court	5		
Owensilla	3		

3. Ballymun Economic Development/Town Civic Alliance

Economic Strategy

The next economic sub-committee meeting is due to take place on 11th March 2017.

Stimulating Economic Activity

Start-Up Ballymun

A Start-Up Ballymun event took place on Wednesday 26th April 2017 in the Council Chamber. The theme for the event was 'The Business of Health & Fitness'. We had six

speakers from the Sport & Fitness sector share their experience of setting up and running a business. They were:

- Michael McCarthy & William Lowry, KSM
- Sean Boland, Be Well Physiotherapist
- Rob Forbes, The Irish Rugby Institute
- Stephen Connolly, Lo-Cal Kitchen
- Yvonne Brady, EVB Sport
- Annette Smith, Tennis4kids (Unfortunately had to withdraw at short notice)

There was free one to one mentoring available on the day. Eight people registered for the event and forty five attended.

Ballymun4Business (B4b)

Since the last report B4b have hosted two network meet-ups for its members. On the 31st March a workshop on 'Wellness & Mindfulness' was delivered by Mary O'Callaghan. Fifteen of our members attended. On 24th April Pamela Connolly did a session with the group on the draft LAP that was very well received. The new website is now live: www.b4b.ie, it is almost complete and the web developer will be delivering training on how to maintain it to some B4b members. Dublin City Council provided the funding for the website.

Enterprise Space

Food Enterprise – The EDO has carried out some research into the viability enterprise space for small food manufacturers in Ballymun. This involved a visit to a number of different food incubators in Dublin. It also included a visit to the Cork Incubator Kitchens in Carrigaline in Cork Co. Co. A draft report of the findings has been shared with the LEO who will commission one of their food mentors to conduct a feasibility study.

Vacant Neighbourhood commercial units

The units in Coultury have been advertised on Daft which has led to an increase in the number of enquiries and viewings

- Negotiations are ongoing with a pharmacy for unit C in Coultury.
- Negotiations were taking place with a barber for unit D in Coultury, but have since stalled due to set-up costs

There are a number of challenges in attempts to dispose of the NC units including:

- Core shell condition that require significant capital investment
- Lengthy disposal process
- Increase in the level of vandalism on some units making them difficult to market

The EDO will look at measures to make the units a more attractive proposition.

The current status of vacant units is:

Location	Ownership	Status	Comments
Coultury Unit B	DCC	T&C's offered for a new café	Planning has been approved for a new café in Coultury.
Coultury Unit C & D	DCC	Vacant	Negotiations to commence with pharmacy on Unit D 2 expressions of interest received on Unit C

Silloogue, Unit 3	DCC	Vacant	This unit is available for viewing by prospective tenants of which there have been quite a few
Unit 1, Gateway	Private	Vacant	KPM Management co.
Santry Cross	Private	For sale ((700k) or rent (70,000)	Core shell with 4 car parking spaces, 7,347 sq. ft.
St. Pappins	Private	TBC	Sign has been taken down. Status unknown

Free Wi-Fi for Plaza – The Wi-Fi installation has been completed and is now fully functional. The Economic sub-committee spoke about running a local competition between local community groups to launch the Wi-Fi once the weather improves. This will be progressed over the coming weeks.

Civic Alliance Update

The next Civic Alliance Meeting will be held on 1st June 2017.

The Draft Ballymun Local Area Plan went on public display on Wednesday 5th April for a period of 6 weeks. Members of planning staff were available in Ballymun Civic Centre on Thursday 6th April, Saturday 22nd April and Wednesday 26 April to discuss and explain the process for preparing a local area plan and to assist with any queries in relation to the plan area.

The next Economic Sub Committee Meeting was held on 11th May 2017, where was an update on the successful “Start Up Ballymun” Event which was held on 26th April in the Council Chamber highlighting the Business of Sport & Fitness and updates on the WiFi, B4B and the vacant neighbourhood units.

The next meeting of the Physical /Environmental Sub Committee will be held on 22nd May 2017.

The next meeting of the Social Sub Committee will be held on 22nd May 2017. There was a meeting held on 24th April 2017 between the Department of Social Protection, Ballymun Job Centre, Dublin City Council and Councillor Andrew Montague to discuss the successful Youth Guarantee Scheme to see what lessons can be learned from it and to discuss the activation process to see if there is scope to look at the needs for Ballymun.

Shopping Centre: The Credit Union recently received planning permission for a new unit in the Ballymun Civic Centre. Construction of their new unit is due to commence in the near future. The Job Centre are also due to commence fit out of their unit in the Civic Centre in the coming weeks.

Northern Site

The legal documents have nearly been completed with Lidl.

Housing site: Balbutcher Lane-Cranogue Road Site, Ballymun-

Sally Reddington, Senior Executive Engineer, in the Environment and Transportation Department is corresponding with Irish Water regarding the disposal of this site. As soon as

Irish Waters position is established, all replies will be reviewed and assuming that there are no objections to the disposal it is proposed to offer the Site to the Market.

Safety Fora Updates

Safer Ballymun

The last meeting of the Safer Ballymun took place on April 11th. It was well attended on the night by residents, DCC staff, member of the Gardaí and local representatives. A presentation on “Creating Male Space” was given on the night by Kerry Lawless from BRYR – this is a new 12 week mental health programme aimed at 18 – 24 year old men. Other issues discussed on the night included drug dealing, anti-social behaviour especially in the parks, illegal dumping and the planned Clean Up Day on Good Friday.

The next meeting is scheduled to take place on Tuesday, June 13th.

Drumcondra Glasnevin Community Forum

The next meeting is scheduled to take place on Wednesday June 28th.

Mary Taylor
Assistant Area Manager

**The Chairman and Members of
North West Area Committee.**

Meeting: 16th May 2017

**Development Department,
Civic Offices.**

Item No: 20

With reference to the proposed disposal of the Council's fee simple interest in the premises at "Viscount House", 89 Swords Road, Whitehall, Dublin 9.

Under Indenture of Lease dated 27th April 1934, Dublin City Council demised a site at 89 Swords Road, Whitehall, Dublin 9 which is more commonly known as the "Viscount House" to John Slevin for a term of 150 years from 25th March 1933 subject to an annual rent of €19.81. Costigo Tavern Limited is the present Lessee.

Previously Council Report No. 06/2004 which was assented to by the Dublin City Council at its meeting on 13th January 2004, approved terms and conditions for the disposal of the fee simple in the premises 89 Swords Road, Whitehall, Dublin 9 to Costigo Tavern Limited. However the legalities were never completed and the terms and conditions as agreed have since lapsed.

Whitney Moore Solicitors acting on behalf of the applicant Costigo Tavern Limited has now re-applied to Dublin City Council to purchase the fee simple therein. The Law Agent has confirmed that there is a statutory entitlement to purchase the fee simple.

Accordingly it is proposed to dispose of the Council's fee simple interest in the "Viscount House", 89 Swords Road, Whitehall, Dublin 9 to Costigo Tavern Limited, subject to the following terms and conditions:

1. The premises is held by Costigo Tavern Limited under Indenture of Lease to John Slevin dated 27th April 1934 for a term of 150 years with effect from the 25th March 1933, subject to the yearly rent of €19.81 per annum.
2. That the property proposed to be disposed of comprises the "Viscount Pub", 89 Swords Road, Whitehall, Dublin 9 which said property is more particularly shown outlined in red and coloured pink on Map index No. 12656.
3. That the purchase price shall be the sum of €12,500 (twelve thousand five hundred euro).
4. That the Council shall transfer the unencumbered freehold title of the lands.
5. That the applicants shall pay any charges which they are liable for under the relevant legislation and shall clear all outstanding rent, rates and taxes (if any) on the property prior to the completion of the sale.
6. That the above proposal is subject to satisfactory proof of title.

7. That the applicant shall pay Valuer's Fees of €1,500 (one thousand and five hundred euro) plus V.A.T. together with the Council's legal fee's which will be agreed with the Council's Law Agent.

Paul Clegg

Executive Manager

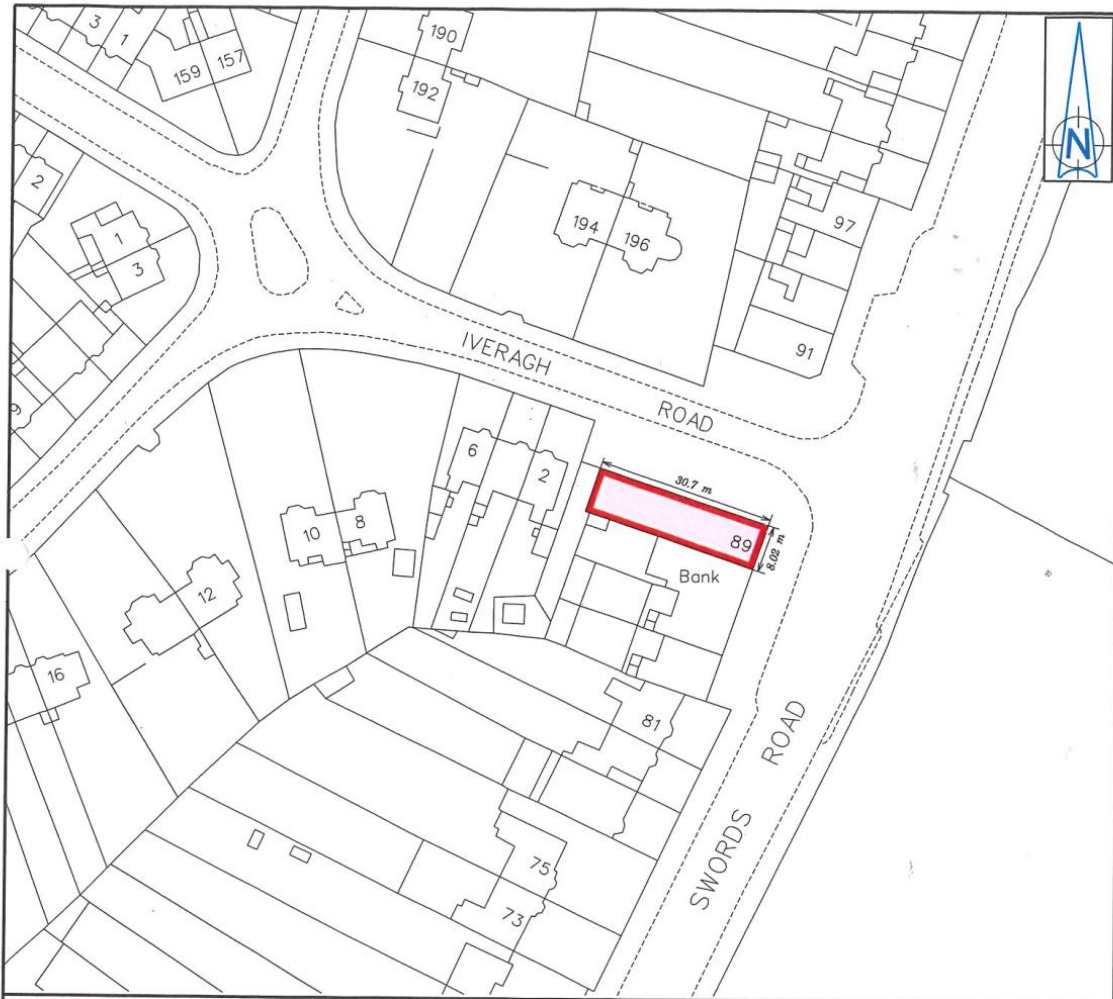

SWORDS ROAD No. 89

DUBLIN CITY COUNCIL TO COSTIGO TAVERN LIMITED

DISPOSAL OF FEE SIMPLE



DUBLIN CITY COUNCIL

Comhairle Cathrach Bhaile Átha Cliath

ENGINEERING DEPARTMENT

An Roinn Innealtóireachta

SURVEY AND MAPPING SECTION

An Rannóg Suirbhéireachta & Léarscúilithe

M. PHILLIPS CITY ENGINEER	Date	By	Revisions :		SCALE 1:1000	INDEX No. 12656
SURVEYED/ MADE BY L.B.	DATE 16-12-2003	O.S. REF. 3132-21		E: 316773 N: 238166	CODE C3	
	If OSi data included : © Ordnance Survey Ireland. All rights reserved. Licence Number 2003 /07/CCMA/Dublin City Council					

**The Chairman and Members of
North West Area Committee.**

Meeting: 16th May 2017

**Development Department,
Civic Offices.**

Item No: 21

With reference to the proposed disposal of fee simple in Coultry Neighbourhood Centre, Ballymun, Dublin 9.

Section 183 Report No. 346/2014 was assented to at a meeting of Dublin City Council on the 1st December 2014.

The report proposed the disposal of Dublin City Council's fee simple interest in the common areas of Coultry Neighbourhood Centre, Ballymun, Dublin 9 to the management company, now named Coultry NC Management Company CLG.

The legal formalities have not yet completed. In compliance with the requirements of the Multi-Unit Developments Act 2011 and by agreement with Coultry NC Management Company CLG, it is proposed to vary Report No. 346/2014 as follows:

1. In addition to the disposal of the Council's fee simple interest in the common areas, the disposal shall also include the apartments, the commercial units and the community unit in Coultry Neighbourhood Centre.

The Council's fee simple interest is subject to a lease held by Ballymun Regeneration Limited for a term of 200 years from the 1st December 2005. The lease will be assigned by Ballymun Regeneration Limited to Coultry NC Management Company CLG and then merged with the fee simple interest when the proposed disposal is complete. Before the assignment of the lease completes, Ballymun Regeneration Limited will have granted long subleases to the Council in the retail/community units.

2. The area to be disposed is shown outlined red on Map Index No. SM-2014-0660-001 and Map Index No. SM-2014-0660-002.

No agreement enforceable at law is created or is intended to be created until an exchange of contracts has taken place.

The disposal shall be subject to any such covenants and conditions as the Law Agent in his discretion shall stipulate.

Paul Clegg
Executive Manager

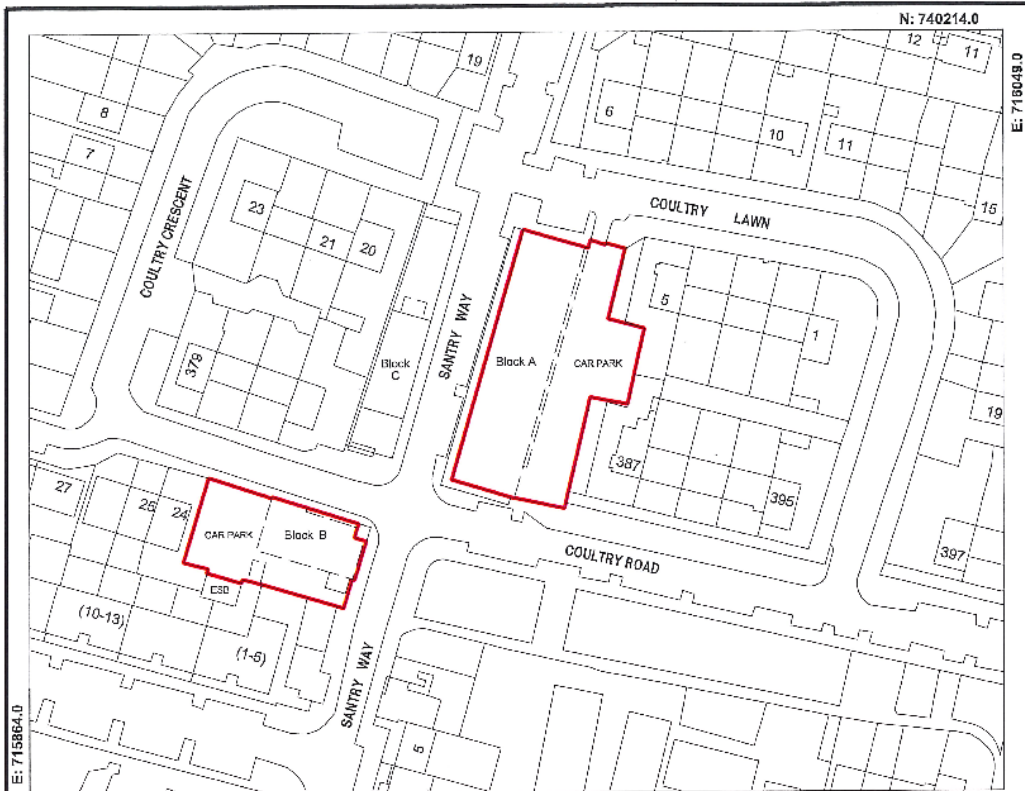

COULTREY NEIGHBOURHOOD CENTRE, COULTREY ROAD, BALLYMUN, DUBLIN 9

Multi-Unit Developments Act 2011 Transfer to Coultrey NC Management Company Limited

Note: APPROVED MSB REF: S2005DN001609R

An Roinn Comhshaoil agus Iompair
Rannán Suirbhéireachta agus Léarscáilithe
 Environment and Transportation Department
 Survey and Mapping Division

O.S REF	SCALE
3131-10,3132-06	1-1000
DATE	SURVEYED / PRODUCED BY
20-03-2017	PMcGinn

FILE NO	INDEX No	FOLDER No	CODE	DWG No	REV
SM-2014-0660_0204-C3-001-A.dgn					

JOHN W. FLANAGAN
 PhD CEng Eur Ing FIEI FICE
 ACTING CITY ENGINEER

THIS MAP IS IDENTIFIED TO BE COMPUTER GENERATED BY DUBLIN CITY COUNCIL FROM ORDNANCE SURVEY DIGITAL MAPBASE

SURVEY, MAPPING AND RELATED RESEARCH APPROVED

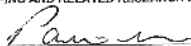
APPROVED 
THOMAS CURRAN
 ACTING MANAGER LAND SURVEYING & MAPPING
 DUBLIN CITY COUNCIL

INDEX No.

SM-2014-0660

-001

OSI data : © Ordnance Survey Ireland. All rights reserved. Licence Number 2017 /23/CCMA/ Dublin City Council